

**COUNTY OF LOS ANGELES
ROAD DEPARTMENT**

**PRECISE
BENCH MARK LIST**



**LANCASTER WEST
QUAD**

1981 ADJUSTMENT

NGVD 29

P R E F A C E
1981 Adjustment

The Road Department level net published in 1975 consisted of more than 1500 miles of levels supporting in excess of 18,000 bench marks. For reasons of economy, this 1981 adjustment is reduced to about 55% of the bench marks previously published. Reductions were made by increasing the spacing between level lines in unincorporated territory, and eliminating lines in non-contract cities and areas where the probability of future engineering projects appears slight. The 1981 adjustment is an update of the remainder of the 1975 bench marks, not including baselines. Data from previous adjustments is available without inferring any responsibility for the current reliability of the data or the actual existence of the bench marks. Elevations of bench marks with the same quad name, but different adjustment dates, are not normally compatible.

To facilitate the adjustment, indexing, and distribution of adjusted values of the net, the County territory is divided into 34 quads or areas. For identification purposes each quad is given a name, viz., "Rosemead," "La Mirada," "Santa Fe," etc. When bench marks and elevations in the Road Department net are used, the name of the quad in which the bench mark is located and the date of the elevation adjustment must be included in the bench mark description, e.g.,

CY 6901 - RDEM TAG S CB 11FT E BCR @ SE COR LA CIENEGA
BLVD & LENNOX BLVD 32FT S & 73FT E C/L INT
(HAWTHORNE - 1980) ELEV. 82.549

The precision of the net is reflected by an indicated field probable error of plus or minus 0.012 foot per mile of leveling as determined from over 300 conditions of closure. However, many years experience in vertical control in the greater Los Angeles basin and Antelope Valley indicate that because of varying degrees of subsidence and heaving, the true datum is recovered only by obtaining substantial agreement between a number of bench marks.

The users of this net are invited to assist in its maintenance by notifying this Department of cases of obliteration, apparent mistakes in descriptions or elevations, and proven disturbance of bench marks.

DATUM: U.S. Coast and Geodetic Survey Sea Level Datum
of 1929, through the medium of the Los Angeles
County Engineer Precise Level Net.

ABBREVIATIONS USED IN BENCH MARK LISTINGS

ABUT -----	Abutment	ECR -----	End of Curb Return
ALG -----	Along	EC -----	End of Curve
ANG PT -----	Angle Point	ENT -----	Entrance
B/W -----	Back of Walk	FL -----	Floor
BCR -----	Beginning of Curb Return	FTG -----	Footing
BC -----	Beginning of Curve	FRWY -----	Freeway
BLDG -----	Building	F/W -----	Front of Walk
BM -----	Bench Mark	GAR -----	Garage
BT SPK -----	Boat or Bolt Spike	HDWL -----	Headwall
BR CAP -----	Brass or Bronze Cap	HSE -----	House
C B -----	Catch Basin	HWY -----	Highway
CTR -----	Center	INT -----	Intersection
C/L -----	Center Line	IP -----	Iron Pipe
C/L INT -----	Center Line Intersection	LT -----	Left
C/L PROD -----	Center Line Produced	LACE -----	L.A. City Engineer
CONC -----	Concrete	LACS -----	L.A. Co. Engineer
COR -----	Corner	LAFC -----	L.A. Co. Flood Control
COE -----	Corps of Engineers	L&BN -----	Lead and Bench Nail
CULV -----	Culvert	L&BR -----	Lead and Brad
CYN -----	Canyon	L&N -----	Lead and Nail
CB -----	Curb	L&SPK -----	Lead and Spike
CS MON -----	Co. Eng. Monument	L&T -----	Lead and Tack
CT SPK -----	Cut Spike	MCR -----	Middle of Curb Return
DPW -----	Dept. of Public Works	MKD -----	Marked
DR -----	Drive or Driveway	MC -----	Middle of Curve
E/O -----	East of	MON -----	Monument

ABBREVIATIONS USED IN BENCH MARKS (CON'T)

N/O ----- North of
NR ----- Near
OPP ----- Opposite
PI ----- Point of Intersection
PK&W ----- PK Nail and Washer
P/L ----- Property Line
POST ----- Point of Semi-Tangent
PP ----- Power Pole
PVMT ----- Pavement
PROD ----- Produced
RD ----- Road
RDBM ----- Road Dept. Bench Mark
RDBM TAG ----- Road Dept. Bench Mark Tag
RR ----- Railroad
RT ----- Right
R/W ----- Right of Way
SDMH ----- Storm Drain Manhole
SMH ----- Sewer Manhole
SPK ----- Spike
ST&W ----- Spike Tin and Washer
S/O ----- South of
TP ----- Telephone Pole
USC&GS ----- U.S. Coast and Geodetic Survey
USGS ----- U.S. Geological Survey
WK ----- Walk
W/O ----- West of

K E R N C O U N T Y
A N G E L E S C O U N T Y

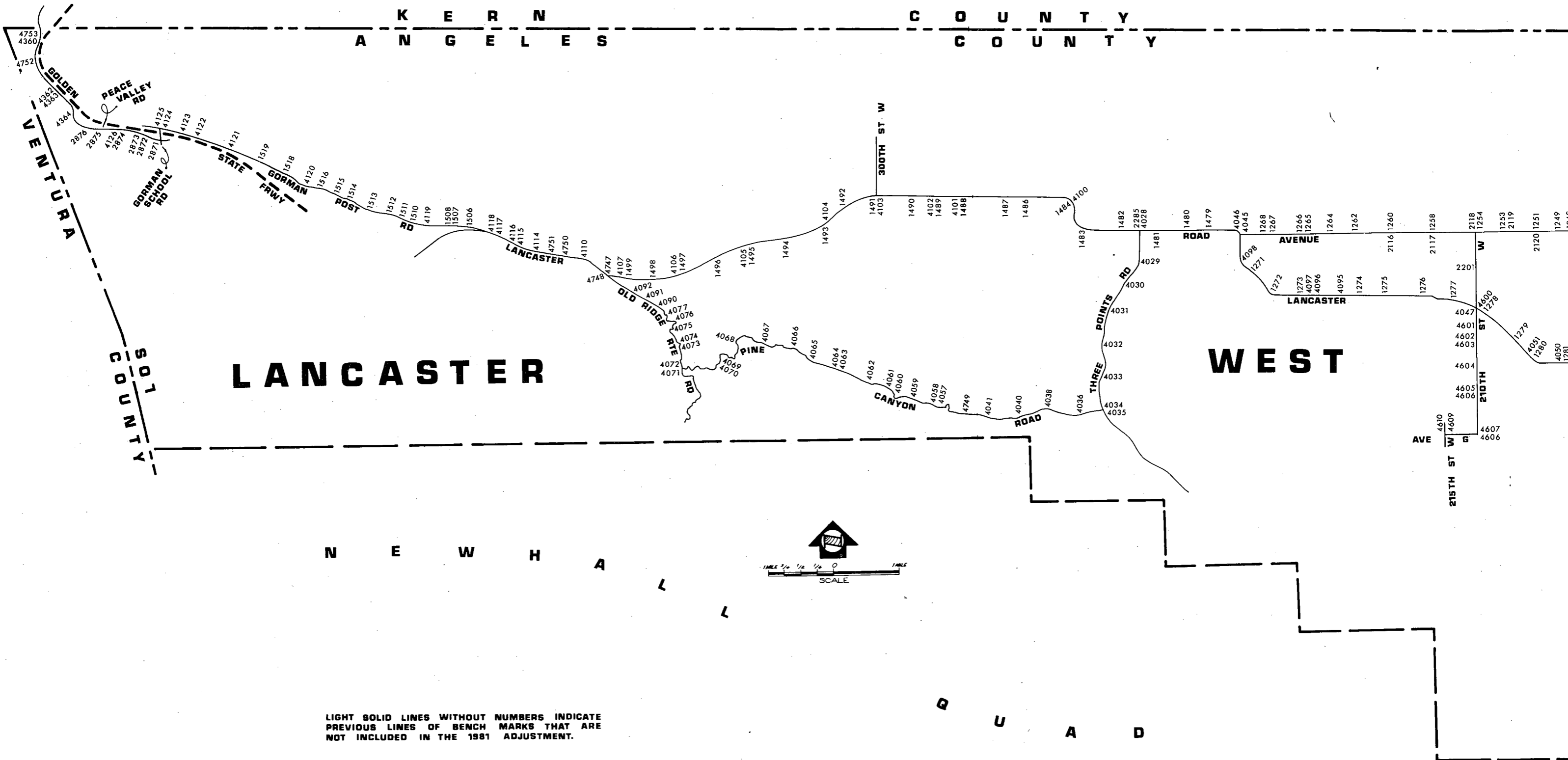

LANCASTER

WEST

LIGHT SOLID LINES WITHOUT NUMBERS INDICATE PREVIOUS LINES OF BENCH MARKS THAT ARE NOT INCLUDED IN THE 1981 ADJUSTMENT.

Q U A R T E R

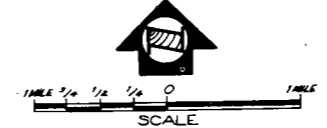

C O U N T Y
C O U N T Y

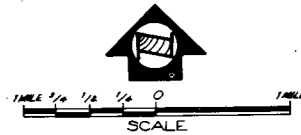
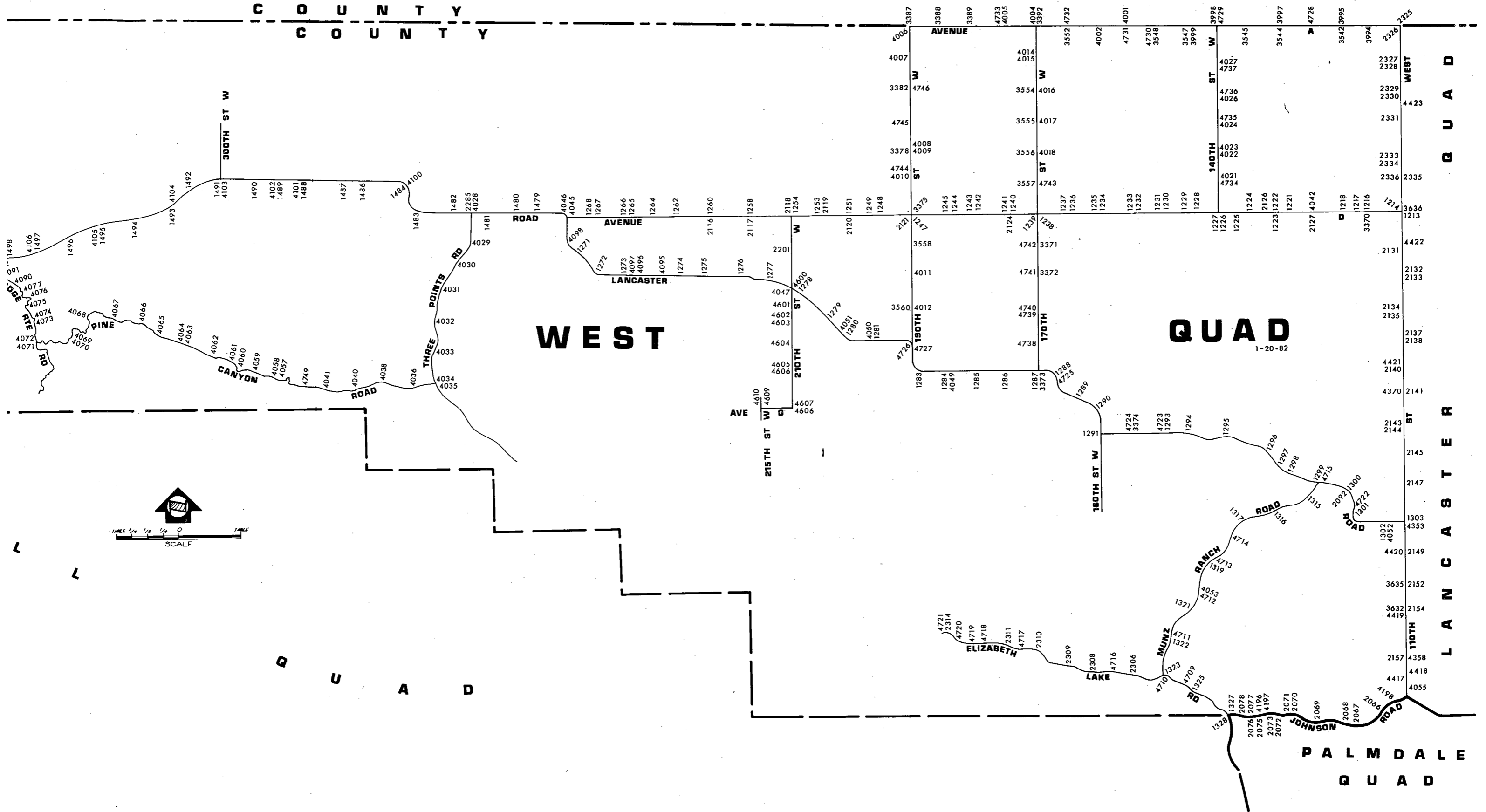

QUAD
1-20-82

WEST
LANCASTER

PALMDALE
QUAD

QUAD-YEAR	ELEV	DESCRIPTION (INCLUDE QUAD AND YEAR IN DESCRIPTION)	BM	NUMBER
LANCASTR (1975)	2485.353	CS MON (SW EDGE) IN WELL 14IN DN @ C/L INT AVE D & 110TH ST W MKD (CO SUR 13 14 23 24 T8N R14W)	CL	1213
LANCASTR (1975)	2487.965	RDBM MON 6FT E PP NO 1218851E 28FT N C/L AVE D & 235FT W C/L 110TH ST W 2IN IP WITNESS 3FT UP 2FT N MKD (1961)	CL	1214
LANCASTR (1981)	2501.710	RDBM MON 6FT E PP NO 1218863E 45FT N C/L AVE D & 195FT W C/L 115TH ST W (DIRT RD) 2IN IP WITNESS 3FT UP 2FT N MKD (1961)	CL	1216
LANCASTR (1981)	2513.490	RDBM TAG IN WEST LEG OF W&P HIGH TENSION LINE TOWER NO 212-4 140FT N C/L AVE D & 165FT E C/L 120TH ST W (PROP BUT UNIMPROVED)	CL	1217
LANCASTR (1981)	2511.770	CS MON 15IN DN @ C/L INT AVE D & 120TH ST W (PROP BUT UNIMPROVED) MKD (T8N R14W SEC CGR 14, 15,22,23) USE N EDGE	CL	1218
LANCASTR (1981)	2542.858	CS MON (N EDGE) IN WELL 20IN DN @ C/L INT AVE D & 130TH ST W MKD (CO.SUR.15 16 21 22 T8N R14W)	CL	1221
LANCASTR (1981)	2545.570	USC&GS MON IN CONC POST 8IN UP 37FT S C/L AVE D & 31FT W C/L 130TH ST W (PROP BUT UNIMPROVED) MKD (WIND 1952)	CL	1222
LANCASTR (1981)	2545.203	USC&GS MON IN CONC POST 6IN UP 63FT S C/L AVE D & 29FT W C/L 130TH ST W (PROP BUT UNIMPROVED) MKD (WIND NO 1 1952)	CL	1223
LANCASTR (1981)	2576.473	RDBM TAG IN CONC BASE OF NORTH LEG OF SO CALIF EDISON HIGH TENSION TOWER NO 51-4 200FT S C/L AVE D & 0.2 MI W 135TH ST W (PROP)	CL	1224
LANCASTR (1981)	2570.885	RDBM TAG IN CONC BASE OF SOUTH LEG OF SO CALIF EDISON HIGH TENSION TOWER NO E51-3-A 60FT N C/L AVE D & 0.2MI W/O 135TH ST W (PROPOSED)	CL	1225
LANCASTR (1981)	2575.381	CS MON IN WELL 18IN DN @ C/L INT AVE D & 140TH ST W MKD (SEC COR 16 17 20 21 T8N R14W) N EDGE	CL	1226
LANCASTR (1981)	2577.203	RDBM MON 6FT E PP NO 1218924E 45FT N C/L AVE D & 153FT W C/L 140TH ST W 2IN IP WITNESS 3FT UP 2FT N	CL	1227
LANCASTR (1981)	2592.988	CS MON (N EDGE) IN WELL 24IN DN @ C/L INT AVE D & 145TH ST W MKD (1/4 COR 17 20 T8N R14W)	CL	1228
LANCASTR (1981)	2595.125	RDBM MON 6FT E PP NO 1218936E 45FT N C/L AVE D & 185FT W C/L 145TH ST W MKD (1961) 2IN IP WITNESS 3FT UP 2FT N	CL	1229

01/18/82

LOS ANGELES COUNTY ROAD DEPARTMENT
SURVEY SECTION

PAGE

QUAD-YEAR	ELEV	DESCRIPTION (INCLUDE QUAD AND YEAR IN DESCRIPTION)	BM	NUMBER
LANCASTR (1981)	2611.196	RDBM MON 6FT E PP NO (NONE) 40FT N C/L AVE D & 1901 E C/L 150TH ST W MKD (1961) 2IN IP WITNESS 3FT UP 2FT N	CL	1230
LANCASTR (1981)	2613.068	CS MON IN WELL 8IN DN @ C/L INT AVE D & 150TH ST W MKD (17 18 19 20 T8N R14W RE 7078)	CL	1231
LANCASTR (1981)	2625.557	RDBM MON 6FT W PP NO (NONE) 40FT N C/L AVE D & 118FT E C/L 155TH ST W MKD (1961) 2IN IP WITNESS 3FT UP 2FT N	CL	1232
LANCASTR (1981)	2625.922	CS MON IN WELL 18IN DN @ C/L INT AVE D & 155TH ST W MKD (1/4 COR 18 19 T8N R14W) USE SW EDGE	CL	1233
LANCASTR (1981)	2645.262	CS MON IN WELL 16IN DN @ C/L INT AVE D & 160TH ST W (DIRT RD) MKD (CO SURV 13 18 1924 T8N R15W)	CL	1234
LANCASTR (1981)	2647.039	RDBM MON 6FT E PP NO (GONE) 28FT N C/L AVE D & 160FT W C/L 160TH ST W (DIRT RD) 2IN IP WITNESS 3FT UP 2FT N	CL	1235
LANCASTR (1981)	2665.167	CS MON IN WELL 8IN DN @ C/L INT AVE D & 165TH ST W MKD (1/4 COR 13 24 T8N R15W RE7078)	CL	1236
LANCASTR (1981)	2667.876	RDBM MON 6FT E PP NO (GONE) 28FT N C/L AVE D & 170FT W C/L 165TH ST W (PROP BUT UNIMPROVED) 2IN IP WITNESS 3FT UP 2FT N	CL	1237
LANCASTR (1981)	2687.535	RDBM MON 6FT E PP NO 1312399E 29FT N C/L AVE D & 75FT E C/L 170TH ST W 2IN IP WITNESS 3FT UP 2FT S	CL	1238
LANCASTR (1981)	2687.167	CS MON IN WELL 8IN DN @ C/L INT AVE D & 170TH W MKD (T8N R15W SEC COR 14 13 23 24 RE 7078) USE S EDGE	CL	1239
LANCASTR (1981)	2711.619	CS MON IN WELL 24IN DN @ C/L INT AVE D & 175TH ST W (PROP) MKD (T8N R15W 1/4 SEC COR 14 23 RE 2177) W EDGE	CL	1240
LANCASTR (1981)	2712.822	RDBM MON IN WELL 6FT E PP NO (NONE) 45FT N C/L AVE D & 170FT W C/L 175TH ST W (PROP) 2IN IP MKR 3FT UP 2FT N MKD (1961)	CL	1241
LANCASTR (1981)	2731.921	RDBM MON IN WELL 9FT E PP NO 1312375E 45FT N C/L AVE D & 48FT E C/L 180TH ST W (PROP) 2IN IP MKR 3FT UP 2FT N MKD (1961)	CL	1242
LANCASTR (1981)	2731.923	CS MON 20IN DN IN WELL @ C/L INT AVE D & 180TH ST W (PROP) MKD (15 14 22 23 RE 2177)	CL	1243

QUAD-YEAR	ELEV	DESCRIPTION (INCLUDE QUAD AND YEAR IN DESCRIPTION)	BM	NUMBE
LANCASTR (1981)	2752.213	RDBM MON IN WELL 8FT W PP NO (GONE) 45FT N C/L AVE D & 220FT E 185TH ST W (PROP) 80FT E HSE NO 18348 MKD (1961) 2IN IP MKR 3FT UP 2FT N	CL	1244
LANCASTR (1981)	2755.047	RDBM TAG @ N EDGE CONC ISL OF GAS PUMP 8FT E OF W END OF ISL 75FT S C/L AVE D & 100FT E C/L 185TH ST W (PROP)	CL	1245
LANCASTR (1981)	2773.405	RDBM IN WELL 8FT E PP NO (GONE) 45FT N C/L AVE D & 190FT W C/L 190TH ST W MKD (1961) 2IN IP MKR 3FT UP 2FT N	CL	1247
LANCASTR (1981)	2787.976	CS MON IN WELL 18IN DN @ C/L INT AVE D & 195TH ST W MKD (1/4 COR 16 21 T8N R15W) USE E EDGE	CL	1248
LANCASTR (1981)	2788.709	RDBM MON IN WELL MKD (1961) 6FT E PP NO 1312339E 45FT N C/L AVE D & 120FT W C/L 195TH ST W (PROP) 2IN IP MKR 3FT UP 2FT N	CL	1249
LANCASTR (1981)	2801.355	RDBM IN WELL MKD (1961) 45FT N C/L AVE D & 185FT W C/L 200TH ST W 6FT E PP NO (GONE) 2IN IP 3FT UP 2FT N	CL	1251
LANCASTR (1981)	2813.736	RDBM MON IN WELL 6FT E PP NO (GONE) 45FT N C/L AVE D & 145FT W C/L 205TH ST W (PROP) 2IN IP MKR 3FT UP 2FT N	CL	1253
LANCASTR (1981)	2817.842	RDBM TAG IN CONC FTG CHAIN LINK FENCE POST OF EDISON SUB-STA @ SW PROP COR 50FT N C/L AVE D & 50FT E C/L 210TH ST W (DIRT RD)	CL	1254
LANCASTR (1981)	2817.580	RDBM MON IN WELL MKD (1961) 7FT E PP NO (GONE) 27FT N C/L AVE D & 185FT W C/L 215TH ST W 2IN IP MKR 3FT UP 2FT N	CL	1258
LANCASTR (1981)	2811.137	RDBM MON IN WELL 14IN DN MKD (1961) 6FT NE PP NO (GONE) 33FT N C/L AVE D & 60FT W 220TH ST W (PROP) 2IN IP MKR 3FT UP 2FT N	CL	1260
LANCASTR (1981)	2824.440	RDBM MON IN WELL 12IN DN MKD (1961) 5FT NE PP NO (GONE) 28FT N C/L AVE D & 180FT W C/L 225TH ST W (PROP) 2IN IP MKR 3FT UP 2FT N	CL	1262
LANCASTR (1981)	2849.302	RDBM MON IN WELL MKD (1961) 30FT N C/L AVE D & 170FT W C/L 230TH ST W 5FT NE PP NO (GONE) 2IN IP MKR 3FT UP 2FT N	CL	1264
LANCASTR (1981)	2878.567	CS MON 22IN DN IN WELL @ C/L INT AVE D & 235TH ST W (TO NORTH) MKD (1/4 COR 14 23 T8N R16W RE 2177) S EDGE	CL	1265

QUAD-YEAR	ELEV	DESCRIPTION (INCLUDE QUAD AND YEAR IN DESCRIPTION)	BM	NUMBE
LANCASTR (1981)	2882.218	RDBM MON IN WELL MKD (1961) 5FT NE PP NO (GONE) 30FT N C/L AVE D & 180FT W C/L 235TH ST W 2IN IP 3FT UP 2FT N	CL	1266
LANCASTR (1981)	2918.933	CS MON 18IN DN @ C/L INT AVE D & 240TH ST W MKD (15 14 23 22 T8N R16W RE 2177) N EDGE	CL	1267
LANCASTR (1981)	2920.566	RDBM MON IN WELL 6FT E OF PP NO (GONE) 28FT N C/L AVE D & 160FT W C/L 240TH ST W 2IN IP 3FT UP 2FT N	CL	1268
LANCASTR (1981)	3014.948	USC&GS MON FLUSH 30FT SW C/L LANCASTER RD & 0.7MI SE AVE D 2FT SE OF WHITE POST MKD (V 305 1935) 2IN IP 3FT UP 0.5FT S	CL	1271
LANCASTR (1981)	3014.475	CSBM MON 6IN UP 50FT SW C/L AVE D-15 (LANCASTER RD) & 0.5MI W 235TH ST W @ CURVE TO NW 18FT S OF S EDGE PROD OF PVMT MKD (BM 102-56 1957)	CL	1272
LANCASTR (1981)	2972.353	CSBM MON 4IN UP 55FT S C/L LANCASTER RD & 575FT W C/L 235TH ST W 25FT E/O TP NO GT8034 MKD(BM 102-55 1957)	CL	1273
LANCASTR (1981)	2943.436	CSBM MON 6IN UP 30FT N C/L AVE D-15 (LANCASTER RD) & 0.25MI W 224TH ST W @ SE COR OLIVE GROVE MKD(BM 102-54 1957) 2IN IP 3FT UP 2FT N	CL	1274
LANCASTR (1981)	2884.641	USC&GS MON IN TOP OF 8IN CONC POST FLUSH 30FT N C/L LANCASTER RD & 0.25MI E/O 224TH ST W MKD(W 305 1935) 2IN IP 3FT UP 1FT S	CL	1275
LANCASTR (1981)	2880.522	CSBM MON 6IN UP 32FT N C/L AVE D-15 (LANCASTER RD & 0.8MI W/O 210TH ST W MKD(BM 102-52 1957) 2IN IP 3FT UP 1FT S	CL	1276
LANCASTR (1981)	2897.476	CSBM MON 6IN UP 49FT N C/L LANCASTER RD & 0.25MI W 210TH ST W MKD (BM 102-51 1957) 2IN IP 3FT UP 2FT S	CL	1277
LANCASTR (1981)	2930.547	CSBM MON 6IN UP 50FT S C/L LANCASTER RD & 1.0MI W/O AVE E-15 0.3MI E/O 210TH ST W MKD (BM 102-50 1957) 2IN IP 3FT UP 1FT N	CL	1278
LANCASTR (1981)	2953.045	USC&GS MON IN TOP OF 8IN CONC POST 14IN UP 30FT W CTR OF PVMT LANCASTER RD 0.45MI N AVE E-15 MKD (X-305 1935) 2IN IP 3FT UP 1FT E	CL	1279
LANCASTR (1981)	2953.406	CSBM MON FLUSH 11FT N C/L PROD LANCASTER D (FROM THE EAST) 67FT S C/L EXISTING PVMT & 0.5MI W/O 195TH ST W (PROP) 13FT W 2IN IP MKD (BM 102- 48 1957) 2IN IP 3FT UP 1FT N	CL	1280

QUAD-YEAR	ELEV	DESCRIPTION (INCLUDE QUAD AND YEAR IN DESCRIPTION)	BM NUMBER
LANCASTR (1981)	2900.732	CSBM MON IN WELL 8IN DN @ INT AVE E-15 (LANCASTER RD) & 195TH ST W 0.5MI W/O 190TH ST W & DN W LINE PROD OF LOT COR MKRS TO N MKD (BM 102-47 1957)	CL 1281
LANCASTR (1981)	2895.844	CSBM MON 6IN UP 55FT S C/L AVE F-8 (LANCASTER RD) & 81FT E C/L PROD 190TH ST W 27FT E PP 2163801E MKD (BM 102-45 1957) 2IN IP 3FT UP 2FT E	CL 1283
LANCASTR (1981)	2871.982	CSBM MON 4IN UP 51FT S C/L AVE F-8 (LANCASTER RD) & 0.5MI E 190TH ST W @ DIRT DRWY HSE 18350 3FT N PP 699381E MKD (BM 102-44 1957) 2IN IP 3FT UP 2FT N	CL 1284
LANCASTR (1981)	2831.571	CSBM MON 4IN UP 55FT S C/L AVE F-8 (LANCASTER RD) & 15FT W C/L 180TH ST W 3FT N PP 699364E MKD (BM 102-43 1957) SURVEY MKR 3FT UP 1FT N	CL 1285
LANCASTR (1981)	2807.973	CSBM MON 6IN UP 57FT S C/L AVE F-8 (LANCASTER RD) & 0.5MI W 170TH ST W 2FT W PP 699359E MKD (BM 102-42 1957) 2IN IP 3FT UP 2FT N	CL 1286
LANCASTR (1981)	2785.285	CSBM MON 4IN UP 36FT S C/L LANCASTER RD & 21FT E C/L PROD 170TH ST W MKD (BM 102-41 1957) SURVEY MKR 3FT UP 1FT N	CL 1287
LANCASTR (1981)	2784.285	USGS MON ON 3 1/2IN IP 43FT W C/L LANCASTER RD (167TH ST W) @ AVE F-8 2FT S FENCE COR MKD(2786)	CL 1288
LANCASTR (1981)	2790.748	CSBM MON FLUSH 2FT ABOVE RD GRADE 25FT N/O C/L LANCASTER RD & 0.5MI W/O 160TH ST W UNDER BARBED WIRE FENCE MKD (BM 102-39 1957)	CL 1289
LANCASTR (1981)	2782.762	CSBM MON 4IN UP 90FT NE C/L 160TH ST W & 0.4MI N LANCASTER RD @ CURVE TO W 29FT E PP NO 699344E MKD (BM 102-38 1957)	CL 1290
LANCASTR (1981)	2829.123	CSBM MON 12IN DN 34FT N C/L LANCASTER RD & 27FT W C/L 160TH ST W MKD (BM 102-37 1957)	CL 1291
LANCASTR (1981)	2748.912	USGS MON 4IN UP 42FT S C/L LANCASTER RD & 2.9MI W MUNZ RANCH RD 70FT E C/L PROD OF DIRT RD TO N 80FT E/O SEC LINE 5 6 T7N R14W MKD (R 39 1929)	CL 1293
LANCASTR (1981)	2679.857	CSBM MON 4IN UP 113FT S C/L LANCASTER RD & 2.4MI W MUNZ RANCH RD ON LEVEL AREA MIDWAY UP A RISE 307FT W OF FENCE COR & 1FT N FENCE MKD (BM 102-34 1957 RE 5869) 2IN IP 2FT N 3FT UP	CL 1294

QUAD-YEAR	ELEV	DESCRIPTION (INCLUDE QUAD AND YEAR IN DESCRIPTION)	BM NUMBER
LANCASTR (1981)	2623.124	CSBM MON 4IN UP 25FT N C/L LANCASTER RD & 1.8MI W MUNZ RANCH RD @ LINE BETWEEN SEC 4 5 T7N R14W UNDER FENCE 3FT W/O COR MKD (BM 102-33 1957 RE 5869) 51FT N PP NO 1559840E & 30FT SW GUY POLE 2014789E	CL 1295
LANCASTR (1981)	2604.402	CSBM MON 3IN UP 25FT N C/L LANCASTER RD & 1.1MI W MUNZ RANCH RD NR PI OF CURVE 3FT S FENCE MKD (BM 102-32 1957 RE 5869) 90FT W/O PRIVATE ST 2IN IP 1FT S 3FT UP	CL 1296
LANCASTR (1981)	2584.979	USC&GS MON FLUSH 4FT BELOW RD GRADE 42FT S C/L LANCASTER RD & 0.7MI W MUNZ RANCH RD 2FT N FENCE MKD (Z 305 1935) 2IN IP 1FT N 3FT UP	CL 1297
LANCASTR (1981)	2581.557	CSBM MON 4IN UP 46FT S C/L LANCASTER RD & 0.5MI W MUNZ RANCH RD 1FT NE FENCE MKD (BM 102-30 1957 RE 5869) 2IN IP 1FT N 3FT UP 55FT SE PP NO 1559802E	CL 1298
LANCASTR (1981)	2567.827	CSBM MON FLUSH 27FT N C/L LANCASTER RD & 30FT W C/L MUNZ RANCH RD 0.6FT N FENCE & 4FT E PP 402818E MKD (BM 102-29 1957 RE 5869)	CL 1299
LANCASTR (1981)	2535.336	CSBM MON 4IN DN 42FT N C/L LANCASTER RD 232FT W/O 120TH ST W MKD (102-28 1958 RE 5869) NO BUTTON 2IN IP 2FT S 3FT UP NR MILEAGE MKR 12.03	CL 1300
LANCASTR (1981)	2546.503	CSBM MON FLUSH 25FT N C/L PROD AVE I & 55FT E C/L PROD 120TH ST W 50FT SE PP NO 2109621E MKD (BM 102-27 1957 RE 5869) BUTTON GONE	CL 1301
LANCASTR (1981)	2519.723	CS MON IN WELL 10IN DN @ C/L INT AVE I & 115TH ST W MKD (1/4 COR 11 14 R14W T7N) USE N EDGE	CL 1302
LANCASTR (1975)	2497.273	CS MON IN WELL 18IN DN 5FT N C/L INT 110TH ST W & AVE I MKD(CO SUR 11 12 13 14 T7N R14W RE 2177)	CL 1303
LANCASTR (1981)	2586.073	CSBM MON 6IN UP 34FT NW C/L MUNZ RANCH RD & 0.4MI S LANCASTER RD 160FT S DIRT DRWY HSE 45715 1FT W INT 4FT BARBED WIRE FENCES MKD (BM 113-8 1960 RE 5869) 2IN IP 2FT SE 3FT UP	CL 1315
LANCASTR (1981)	2617.706	CSBM MON 4IN DN 2FT BELOW PVMT GRADE 26FT SE C/L MUNZ RANCH RD 0.8MI S LANCASTER RD MKD (BM 113-7 1960 RE 5869) 2IN IP 3FT UP 2FT W	CL 1316
LANCASTR (1981)	2676.842	CSBM MON 6IN UP 32FT N C/L MUNZ RANCH RD & 3.0MI N ELIZABETH LAKE RD 1100 FT NE POWER LINE CROSSING MKD (BM 113-6 1960 RE 5869) 2IN IP 3FT UP 2FT N	CL 1317

QUAD-YEAR	ELEV	DESCRIPTION (INCLUDE QUAD AND YEAR IN DESCRIPTION)	BM NUMBER
LANCASTR (1981)	2804.026	CSBM MON 2FT DN 4FT BELOW PVMT GRADE 30FT S C/L MUNZ RANCH RD & 2.1MI N ELIZABETH LAKE RD @ EAST END OF CULVERT @ MILEAGE MARKER 2.30 MKD (BM 113-4 1960 RE 5869)	CL 1319
LANCASTR (1981)	3069.256	CSBM MON 6IN UP 33FT N C/L MUNZ RANCH RD & 1.1MI N ELIZABETH LAKE RD 160FT NE TP 29139M & 120FT NW TP 29138M MKD (BM 113-2 1960)	CL 1321
LANCASTR (1981)	3233.509	CSBM MON 6IN DN 27FT E C/L MUNZ RANCH RD 0.55 MI N ELIZABETH LAKE RD 2FT E PP 307253E MKD (BM 113-1 1960 RE 5869) 2IN IP 3FT UP 2FT E	CL 1322
LANCASTR (1981)	3296.655	CSBM MON 6IN DN 44FT E/O C/L MUNZ RANCH RD 71FT N/O C/L ELIZABETH LAKE RD 3FT N/O PP 29176M MKD (BM 111-32 1960 RE 5869) 2IN IP 2FT ELY 2FT UP	CL 1323
LANCASTR (1981)	3286.620	L&BT SPK 1FT FROM N END W HDWL 79FT S & 35FT W C/L INT ELIZABETH LAKE RD & RANCH CLUB RD	CL 1325
BASELINE (1973)	3332.668	CS MON 2IN UP 27FT N & 38FT E C/L INT ELIZABETH LAKE RD & JOHNSON RD @ INT W C/L DR TO ELIZABETH MISSION CHATHOLIC CHURCH MKD (PC 21 RE 63)	CL 1327
BASELINE (1973)	3329.772	US FOREST RESERVE IP & MON 30FT S & 40FT E C/L INT JOHNSON RD & ELIZABETH LAKE RD @ NW COR 4FT BARBED WIRE FENCE 3FT W PP NO 107478E MKD (BOUNDARY POST NO 83 1905)	CL 1328
LANCASTR (1981)	2971.836	CSBM MON 6IN UP 61FT N C/L HWY 138 & 0.45MI W 245TH ST W ON W SIDE DIRT DR HSE 24715 & 10FT NW PP NO (GONE) MKD (BM 102-59 1957) 2IN IP 3FT UP 1FT S	CL 1479
LANCASTR (1981)	3017.785	CSBM MON 6IN UP 29FT N C/L HWY 138 & 0.9MI W 245TH ST W 6FT W PP NO (GONE) MKD (BM 102-60 1957 RE 5869) USC&GS MKR 2FT UP 1FT S	CL 1480
LANCASTR (1981)	3046.370	LAC DEPT WATER & POWER MON ON 3IN IP FLUSH 26FT S C/L LANCASTER RD & 17FT E/O CTR DIRT DR 0.2MI E/O THREE POINTS RD MKD (104A BENCH MARK) USC&GS MKR 0.5 N	CL 1481
LANCASTR (1981)	3052.362	CSBM MON 29FT N C/L LANCASTER RD & 0.35MI W/O THREE POINTS RD 6FT W/O PP NO (GONE) & 12FT SE 4FT IRRIGATION STANDPIPE MKD (BM 102-62 1957) 2IN IP MKR 3FT UP 2FT W	CL 1482
LANCASTR (1981)	3051.125	CSBM MON 6IN UP 70FT S C/L LANCASTER RD 89FT E/O BC OF CURVE TO N INTO 270TH ST W MKD (102-63 1957 RE 5869) 68FT W/O GUY POLE NO 1123728E USC&GS MKR 2FT UP 1FT N	CL 1483

QUAD-YEAR	ELEV	DESCRIPTION (INCLUDE QUAD AND YEAR IN DESCRIPTION)	BM NUMBER
LANCASTR (1981)	2992.102	USC&GS MON 2IN UP 60FT S C/L LANCASTER RD @ W END CURVE FROM 270TH ST W OPPOSITE HSE NO 27011 22FT SW PP NO (GONE) MKD (U305 1935) 2IN IP 3FT UP 2FT N	CL 1484
LANCASTR (1981)	3009.136	BT SPK 1FT N/O S END OF HDWL OF CULV 29FT S C/L LANCASTER RD & 0.4MI W/O 270TH ST W MKD(102-65A)	CL 1486
LANCASTR (1981)	3037.045	CSBM MON 3IN UP 49FT S C/L LANCASTER RD @ 280TH ST W 4FT W/O PP NO 1122597E MKD (BM 102-66 1957) USC&GS MKR 1FT N	CL 1487
LANCASTR (1981)	3043.249	CSBM MON 2IN UP 49FT S C/L LANCASTER RD & 190FT W C/L INT MARAGLO ST (DIRT) @ METTLER VALLEY HOME SITES 4FT W/O PP NO (GONE) MKD (BM 102-67 1957) USC&GS MKR 1FT N	CL 1488
LANCASTR (1981)	3020.538	USC&GS MON 10IN DN 49FT S C/L LANCASTER RD @ DIRT RD TO HSE NO 29300 1.0MI E/O 300TH ST W 19FT E/O FENCE COR 83FT E/O CULV 82FT E/O PP NO 1123700E MKD(T 305 1935) 2IN IP 3FT UP 1FT N	CL 1489
LANCASTR (1981)	3041.971	CSBM MON 6IN UP 49FT S C/L HWY 138 & 0.5MI E 300TH ST W 4FT W PP NO (GONE) & 39FT E/O FENCH LINE PROD MKD (BM 102-69 1957) USC&GS MKR 1FT N	CL 1490
LANCASTR (1981)	3044.053	CSBM MON 6IN UP 48FT S C/L HWY 138 & 215FT E C/L 300TH ST W OPP HSE 29853 4FT W PP 1123722E & 6FT E/O FENCE COR MKD (BM 102-70 1957) USC&GS MKR 1FT N	CL 1491
LANCASTR (1981)	3088.282	CSBM MON 4IN UP 50FT NW C/L HWY 138 & 0.6MI W 300TH ST W 87FT W OF W END HDWL CULV 211&43 10FT N PP NO (GONE) & 5FT SW FENCE COR MKD (BM 102-71 1957 RE 5869) USC&GS MKR 1FT S	CL 1492
LANCASTR (1981)	3123.361	CSBM MON 6IN UP 49FT S C/L HWY 138 & 3.4MI E OLD RIDGE RTE 16FT W CATTLE GATE MKD (BM 102-72 1957) USC&GS MKR 1FT N	CL 1493
LANCASTR (1981)	3143.859	CSBM MON 2IN UP 49FT S C/L HWY 138 & 2.8MI E/O OLD RIDGE RTE 20FT S/O S END HDWL CULV 156+09 MKD (BM 102-73 1957) USC&GS MKR 1FT N	CL 1494
LANCASTR (1981)	3169.329	CSBM MON 6IN UP 48FT S C/L HWY 138 & 2.4MI E OLD RIDGE RTE 18FT S OF S END CULV A133+60 MKD (BM 102-74 1957) USC&GS MKR 1FT N	CL 1495
LANCASTR (1981)	3209.929	CSBM MON 4IN UP 48FT S C/L LANCASTER RD (HWY 138 16FT S/O S END CONC HDWL & 1.8MI E/O OLD RIDGE RTE RD MKD (BM 102-75 1957) USC&GS MKR 1FT N	CL 1496

QUAD-YEAR	ELEV	DESCRIPTION (INCLUDE QUAD AND YEAR IN DESCRIPTION)	BM NUMBER
LANCASTR (1981)	3270.953	USC&GS MON FLUSH 50FT N C/L HWY 138 & 1.4MI E OLD RIDGE RTE 485FT E CULV 75+78 75FT E PP NO (GONE) MKD (R 305 1935) 2IN IP 3FT UP 1FT S	CL 1497
LANCASTR (1981)	3339.285	CSBM MON 6IN UP 49FT S C/L HWY 138 & 0.75MI E OLD RIDGE RTE 17FT S OF S END CONC HDWL CULV 51+ 15 MKD (BM 102-77 1957) USC&GS MKR 1FT N	CL 1498
LANCASTR (1981)	3395.615	CSBM MON 6IN UP 48FT S C/L HWY 138 & 0.4MI E OLD RIDGE RTE 10FT E FENCE COR MKD (BM 102-78 1957) 2IN IP 3FT UP 1FT N	CL 1499
LANCASTR (1981)	3335.325	USC&GS MON 5IN UP 37FT S C/L GORMAN POST RD @ INT W/DIRT RD TO S 25FT W/O SW COR OF CATTLE GUARD 6FT N/O PP NO 1699201E 0.1MI W/O INT OF LANCASTER RD MKD(Q 452 1953) MKR POST 1.7FT W	CL 1506
LANCASTR (1981)	3382.965	USC&GS MON 9IN UP 94FT SE C/L GORMAN POST RD (HWY 138) 0.4MI W/O LANCASTER RD ON SW SIDE OF SMALL HILL 9FT S/W OF PP NO 1707769E MKD (Z53 1926 RESET 1953) MKR POST 2FT W	CL 1507
LANCASTR (1981)	3398.972	USC&GS MON 4FT W/O E END N HDWL OF CULV NO 0.60 21FT N C/L GORMAN POST RD & 0.5MI W/O LANCASTER RD MKD(P 452 1953)	CL 1508
LANCASTR (1981)	3585.117	USC&GS MON 5IN UP 48FT NE C/L GORMAN POST RD & 1.1MI W/O LANCASTER RD 24FT S C/L DIRT RD TO E MKD(B 370 1953) MKR POST 1.8FT NW	CL 1510
LANCASTR (1981)	3562.646	USC&GS MON 6IN UP 82FT N C/L GORMAN POST RD & 1.2MI W/O LANCASTER RD @ W END OF CUT 25FT NW C/L DIRT RD TO NE MKD(M452 1953) MKR POST 1.4FT W	CL 1511
LANCASTR (1981)	3482.094	USC&GS MON 1FT W/O E END S HDWL OF CULV NO 1.80 28FT S C/L GORMAN POST RD 1.6MI W/O LANCASTER RD MKD(I 452 1953)	CL 1512
LANCASTR (1981)	3458.873	USC&GS MON 4IN UP 41FT S C/L GORMAN POST RD & 1.8MI W/O LANCASTER RD 30FT SW OF S END OF CULV NO 2.00 MKD(A 370 1953) MKR POST 1.5FT W	CL 1513
LANCASTR (1981)	3481.728	USC&GS MON 6IN UP 42FT S C/L GORMAN POST RD & 2.0MI W/O LANCASTER RD NR POWER LINE CROSSING 50FT W/O NW END S HDWL OF CULV NO 2.20 MKD(K 452 1953) MKR POST 1.5FT NW	CL 1514
LANCASTR (1981)	3485.442	USC&GS MON 5IN UP 31ST S C/L GORMAN POST RD & 2.3MI W/O LANCASTER RD 47FT W/O TP NO 25-41 MKD(J 452 1953) MKR POST 1.3FT W	CL 1515

QUAD-YEAR	ELEV	DESCRIPTION (INCLUDE QUAD AND YEAR IN DESCRIPTION)	BM NUMBER
LANCASTR (1981)	3512.914	USC&GS MON 5IN UP 36FT SW C/L GORMAN POST RD & 2.6MI W/O LANCASTER RD 68FT SE OF END OF S HDWL OF CULV NO 2.90 15FT W/O TP NO 15-41 MKD(A 54 1926) MKR POST 1.4FT E	CL 1516
LANCASTR (1981)	3558.441	USC&GS MON 5IN UP 39FT NE C/L GORMAN POST RD & 3.1MI W/O LANCASTER RD 79FT SE/O PP NO 1061807E MKD(G 452 1953) MKR POST 1.7FT SE	CL 1518
LANCASTR (1981)	3599.992	USC&GS MON 5IN UP 50FT N/O C/L GORMAN POST RD & 1.5MI E/O GORMAN SCHOOL RD 2FT W/O SE COR FENCE AROUND EDISON GORMAN SUB-STA 42FT NE/O PP NO (GONE) MKD (F 452 1953) MKR POST 1.7FT W	CL 1519
BASELINE (1973)	3057.730	USGS MON @ SE COR JOHNSON RD & DIRT RD TO FOOTHILL RANCH 105FT S APPROX C/L JOHNSON RD & 2.5MI E ELIZABETH LAKE RD MKD (R 43 1925)	CL 2066
BASELINE (1973)	3192.814	RDBM TAG CONC & ROCK HDWL 11.79 15FT N APPROX C/L JOHNSON RD & 2.1MI E ELIZABETH LAKE RD	CL 2067
BASELINE (1973)	3194.232	CSBM MON 6IN UP 28FT N APPROX C/L JOHNSON RD & 2.1MI E ELIZABETH LAKE RD 22FT NE CULV 11.79 MKD (BM 119-31 1961)	CL 2068
BASELINE (1973)	3347.390	CSBM MON 6IN UP 35FT N APPROX C/L JOHNSON RD & 1.6MI E ELIZABETH LAKE RD 31FT NE CULV 12.25 MKD (BM 119-32 1961)	CL 2069
BASELINE (1973)	3408.062	RDBM TAG CONC & ROCK HDWL 12.39 25FT N APPROX C/L JOHNSON RD & 1.5MI E ELIZABETH LAKE RD	CL 2070
BASELINE (1973)	3438.552	CS MON 6IN UP 200FT N APPROX C/L JOHNSON RD & 1.5MI E ELIZABETH LAKE RD MKD (1/4 COR 27 34 T7N R14W)	CL 2071
BASELINE (1973)	3522.765	CSBM MON 6IN UP 31FT S APPROX C/L JOHNSON RD & 1.25 MI E ELIZABETH LAKE RD @ SUBM MKD (BM 119-33 1961)	CL 2072
BASELINE (1973)	3455.350	CS MON 1IN DN 55FT S APPROX C/L JOHNSON RD & 1.0MI E ELIZABETH LAKE RD MKD (SEC COR 28 27 33 34 T7N R14W) USS N EDGE	CL 2073
BASELINE (1973)	3476.698	CSBM MON 6IN UP 38FT S APPROX C/L JOHNSON RD & 0.75MI E ELIZABETH LAKE RD NE E SIDE OF ENT LEONA VALLEY HUNTING CLUB MKD (BM 119-34 1961)	CL 2075
BASELINE (1973)	3415.085	CS MON FLUSH 100FT S APPROX C/L JOHNSON RD & 0.5MI E ELIZABETH LAKE RD MKD (1/4 COR 28 33 R14W T7N)	CL 2076

QUAD-YEAR	ELEV	DESCRIPTION (INCLUDE QUAD AND YEAR IN DESCRIPTION)	BM NUMBER
BASELINE (1973)	3408.120	L&DATE SPK SE CONC BASE TOWER 220/6 140FT N APPROX C/L JOHNSON RD & 0.4MI E ELIZABETH LAKE RD	CL 2077
BASELINE (1973)	3395.296	CSBM MON 6IN UP 28FT N APPROX C/L JOHNSON RD & 0.3MI E ELIZABETH LAKE RD MKD (BM 119-35 1961)	CL 2078
LANCASTR (1981)	2534.457	CS MON 14IN DN @ C/L INT 120TH ST W & FUT AVE H-8 MKD (1/4 COR 10 11 R14W T7N RE 2177) USE S EDGE 2IN IP MKR 3FT UP 2FT N	CL 2092
LANCASTR (1981)	2812.174	CS MON IN WELL 11IN DN @ C/L INT AVE D & FUT 220TH ST W MKD (T8N R15W SEC COR 13 18 19 24 RE2177) USE N EDGE	CL 2116
LANCASTR (1981)	2817.137	CS MON IN WELL 7IN DN @ C/L INT AVE D & 215TH ST W MKD (T8N R15W 1/4 SEC COR 18 19 RE 2177) USE N EDGE	CL 2117
LANCASTR (1981)	2817.299	CS MON IN WELL 8IN DN @ C/L INT AVE D & 210TH ST W MKD (T8N R15W SEC COR 18 17 20 19) SE EDGE	CL 2118
LANCASTR (1981)	2812.496	CS MON IN WELL 10IN DN @ C/L INT AVE D & 205TH ST W MKD (T8N R15W 1/4 SEC COR 17,20 RE 2177)	CL 2119
LANCASTR (1981)	2801.172	CS MON IN WELL 10IN DN @ C/L INT AVE D & FUT 200TH ST W MKD (T8N R15W SEC COR 17 16 21 20 RE 2177) USE S EDGE	CL 2120
LANCASTR (1981)	2772.322	CS MON IN WELL 24IN DN @ C/L INT AVE D & 190TH ST W MKD (T8N R15W SEC COR 16 15 21 22 RE 2177) USE S EDGE	CL 2121
LANCASTR (1981)	2713.865	CSBM MON (S SIDE) 15FT W & 30FT N C/L INT 175TH ST W & AVE D MKD (BM 117-39 1961 RE5869) 2IN IP MKR 3FT UP 2FT SE	CL 2124
LANCASTR (1981)	2563.273	CS MON IN WELL 7IN DN @ C/L INT 135TH ST W & AVE D MKD (1/R COR 16 21 T8N R14W RE5869)	CL 2126
LANCASTR (1981)	2527.901	USC&GS MON 6IN UP 45FT N & 8FT E C/L INT AVE D & 125TH ST W MKD (WIND 1952) 2IN IP 3FT UP 4FT E	CL 2127
LANCASTR (1975)	2488.977	CSBM MON 72FT S & 32FT E C/L INT AVE D-8 & 110TH ST W MKD (BM 119-42 1961)	CL 2131
LANCASTR (1975)	2481.324	CS MON (NE EDGE) IN WELL 18IN DN @ C/L INT 110TH ST W & AVE E MKD (CO SUR 23 24 25 26 R14W T8N)	CL 2132
LANCASTR (1975)	2485.274	CSBM MON 6IN UP 117FT S & 30FT W C/L INT 110TH ST W & FUT AVE E MKD (BM 119-43 1961)	CL 2133

QUAD-YEAR	ELEV	DESCRIPTION (INCLUDE QUAD AND YEAR IN DESCRIPTION)	BM NUMBER
LANCASTR (1975)	2494.262	CS MON IN WELL 13IN DN @ C/L INT 110TH ST W & AVE E-8 30FT E PP 1222609E MKD (CO SUR 1/4SEC COR 25 26 T8N R14W)	CL 2134
LANCASTR (1975)	2496.363	CSBM MON 6IN UP 110FT S & 30FT W C/L INT 110TH ST W & AVE E-8 110FT S PP 1222609E MKD (BM 119-44 1961)	CL 2135
LANCASTR (1975)	2516.189	CSBM MON 6IN UP 260FT S & 35FT W C/L INT 110TH ST W & FUT AVE F MKD (BM 119-45 1961)	CL 2137
LANCASTR (1975)	2514.869	CS TRI STA MON 8IN UP 493FT S & 38FT W C/L INT AVE F & 110TH ST W MKD (DEL SUR G-1 ECC 1 1964)	CL 2138
LANCASTR (1975)	2490.811	CSBM MON 6IN UP 240FT S & 30FT W C/L INT 110TH ST W & AVE F-8 92FT N PP 1222581E MKD (BM 119-46 1961)	CL 2140
LANCASTR (1975)	2493.009	CS MON (N EDGE) IN WELL 12IN DN @ C/L INT 110TH ST W & AVE G MKD (SEC COR 35 36 1 2 R14W T7N T8N)	CL 2141
LANCASTR (1975)	2494.373	CS MON (W EDGE) IN WELL 12IN DN @ C/L INT 110TH ST W & AVE G-8 MKD (1/4 COR 1 2 R14W T7N)	CL 2143
LANCASTR (1975)	2499.024	CSBM MON 35FT W C/L 110TH ST W & 365FT S AVE G-8 MKD (BM 119-21 1961)	CL 2144
LANCASTR (1975)	2494.618	CS MON (E EDGE) IN WELL 24IN DN @ C/L INT 110TH ST W & AVE H MKD (SEC COR 1 2 11 12 T7N R14W)	CL 2145
LANCASTR (1975)	2500.017	CS MON (E EDGE) IN WELL 12IN DN @ C/L INT 110TH ST W & AVE H-8 MKD (1/4 COR 11 12 T7N R14W)	CL 2147
LANCASTR (1975)	2504.622	CS MON IN WELL 8IN DN @ C/L INT 110TH ST W & AVE I-8 MKD (1/4 COR 13 14 T7N R14W RE 5869)	CL 2149
LANCASTR (1975)	2535.534	USC&GS TRI STA MON FLUSH ON SW COR AVE J & 110TH ST W 45FT W & 40FT S C/L INT MKD (SUR 1932)	CL 2152
LANCASTR (1975)	2581.323	CS MON IN WELL 17IN DN @ C/L INT 110TH ST W & AVE J-8 MKD (1/4 COR 23 24 T7N R14W RE 5869) USE N EDGE	CL 2154
LANCASTR (1975)	2681.629	CSBM MON 6IN UP ON SW COR AVE K & 110TH ST W 82FT S & 27FT W C/L INT MKD (BM 119-27 1961)	CL 2157
LANCASTR (1981)	2855.260	CS MON IN WELL 11IN DN @ C/L INT AVE D-8 & 210TH ST W MKD (1/4 COR 19 20 R15W T8N RE 2177)	CL 2201

QUAD-YEAR	ELEV	DESCRIPTION (INCLUDE QUAD AND YEAR IN DESCRIPTION)	BM NUMBER
LANCASTR (1981)	3049.161	CSBM MON 4IN UP ON SE COR LANCASTER RD & THREE POINTS RD 90FT S & 20FT E C/L INT MKD (BM 111-62 1960 RE 5869)	CL 2285
LANCASTR (1981)	3305.085	CSBM MON 6IN DN 34FT N C/L ELIZABETH LAKE RD & .45MI W MUNZ RANCH RD 10FT N PP NO 1698942E 31FT WLY MILEAGE MKR 17.81 MKD (BM 111-33 1960 RE 5869)	CL 2306
LANCASTR (1981)	3295.614	USGS MON 4IN UP 123FT S C/L ELIZABETH LAKE RD & 1.0MI W/D MUNZ RANCH RD MKD (K 191929) 2IN MKR PIPE 2FT N	CL 2308
LANCASTR (1981)	3287.492	CSBM MON 6IN UP 29FT N C/L ELIZABETH LAKE RD & 1.5MI W MUNZ RANCH RD 32FT ELY MILEAGE MKR 18.85 MKD (BM 111-35 1960 RE 5869) MKR POST 1FT S	CL 2309
LANCASTR (1981)	3289.549	USC&GS MON 4IN UP @ NE COR ELIZABETH LAKE RD & ENT TO UNION SCHOOL 75FT N & 20FT E APPROX C/L INT 0.9MI E MOUNTAIN VIEW RD MKD (S 975 1964)	CL 2310
LANCASTR (1981)	3278.266	CS MON 4IN UP 220FT N C/L ELIZABETH LAKE RD @ FIRE DEPT PINE CYN STA 18FT NE OF NW COR FIRE ENGINE GARAGE 0.5MI E MOUNTAIN VIEW RD MKD (23 24 25 26 T7N R15W 1928) W EDGE 2IN IP 2FT NE 3FT UP	CL 2311
LANCASTR (1981)	3249.161	USGS MON 6IN UP 55FT N C/L ELIZABETH LAKE RD & 37FT E C/L INT LAKE HUGHES RD MKD (R 23 1929) 2IN IP MKR 3FT S	CL 2314
LANCASTR (1975)	2485.549	CSBM MON 8IN DN ON SE COR AVE A & 110TH ST W 28FT S & 75FT E C/L INT MKD (BM 117-20 1961) 2IN IP 3FT UP 2FT N	CL 2325
LANCASTR (1975)	2483.903	CS MON IN WELL 24IN DN @ C/L INT AVE A & 110TH ST W MKD (35 36 2 1 R14W T8N T9N) USE S EDGE	CL 2326
LANCASTR (1975)	2486.980	CSBM MON 4IN UP 300FT N & 30FT W C/L INT AVE A-8 & 110TH ST W MKD (BM 119-36 1961) 2IN IP 3FT UP 2FT E	CL 2327
LANCASTR (1975)	2485.890	CS MON IN WELL 11IN DN @ C/L INT AVE A-8 & 110TH ST W MKD (1/4 COR 2 1 T8N R14W RE 5869) USE S EDGE	CL 2328
LANCASTR (1975)	2482.674	CS MON IN WELL 19IN DN @ C/L INT 110TH ST W & AVE B MKD (CO SUR 2 1 11 12 T8N R14W) USE E EDGE	CL 2329
LANCASTR (1975)	2484.946	CSBM MON 4IN UP ON NE COR AVE B & 110TH ST W 28FT N & 55FT E C/L INT MKD (BM 119-37 1961) 2IN IP 3FT UP 2FT E	CL 2330

QUAD-YEAR	ELEV	DESCRIPTION (INCLUDE QUAD AND YEAR IN DESCRIPTION)	BM NUMBER
LANCASTR (1975)	2484.227	CS MON IN WELL 15IN DN @ C/L INT 110TH ST W & AVE B-8 MKD (CO SUR 1/4 SEC COR 11 12 T8N R14W) USE S EDGE	CL 2331A
LANCASTR (1975)	2483.397	CS MON IN WELL 19IN DN @ C/L INT 110TH ST W & AVE C MKD (CO SUR 11 12 13 14 T8N R14W) S EDGE	CL 2333A
LANCASTR (1975)	2486.132	CSBM MON 4IN UP @ SE COR 110TH ST W & AVE C 85FT S & 27FT E C/L INT MKD (BM 119-39 1961) 2IN IP 3FT UP 2FT W	CL 2334A
LANCASTR (1975)	2482.619	CS MON IN WELL 14IN DN @ C/L INT 110TH ST W & AVE C-8 MKD (CO SUR 1/4 SEC COR 14 13 T8N R14W) USE E EDGE	CL 2335A
LANCASTR (1975)	2485.578	CSBM MON 6IN UP ON SW COR 110TH ST W & AVE C-8 95FT S & 25FT W C/L INT MKD (BM 119-40 1961) 2IN IP 3FT UP 2FT E	CL 2336A
LANCASTR (1981)	3816.672	L & T IN CONC HDWL 58FT S & 60FT W C/L INT PEACE VALLEY RD & GORMAN SCHOOL RD 500FT S/D GOLDEN STATE FRWY OVERPASS	CL 2871
LANCASTR (1981)	3843.117	L&BN W END CONC HDWL 55FT S C/L PEACE VALLEY RD 0.15MI W GORMAN SCHOOL RD NR MKR NO 3.50MKD (BM)	CL 2872
LANCASTR (1981)	3840.889	L&BN W END CONC HDWL 45FT N C/L PEACE VALLEY RD 0.15MI W GORMAN SCHOOL RD NR MKR NO 3.50MKD (BM)	CL 2873
LANCASTR (1981)	3906.488	L & BN 5FT W/O E END OF CONC HDWL 40FT S C/L PEACE VALLEY RD & 0.45MI W/O GORMAN SCHOOL RD NR RD MKR NO 3.20 MKD BM	CL 2874
LANCASTR (1981)	3925.292	L&BN IN CTR CONC HDWL 50FT S C/L PEACE VALLEY RD & 0.6MI W/O GORMAN SCHOOL RD NR RD MKR NO 3.00 35FT W/O MAC DR TO CIRCLE R RANCH	CL 2875
LANCASTR (1981)	3962.276	L&BN CTR CONC HDWL 55FT S C/L PEACE VALLEY RD & 0.75MI W GORMAN SCHOOL RD NR MKR NO 2.70MKD (BM)	CL 2876
LANCASTR (1981)	2501.141	CS MON (S EDGE) IN WELL 10IN DN @ C/L INT AVE D & 115TH ST W MKD (1/4 COR 14 23 T8N R14W RE5869)	CL 3370
LANCASTR (1981)	2709.825	CS MON 24IN DN 12FT W/O TRAVELED RD WAY @ C/L INT 170TH ST W & PROP AVE D-8 MKD (1/4 COR 23 24 T8N R15W)	CL 3371
LANCASTR (1981)	2734.604	CS MON 15IN DN @ C/L INT 170TH ST W & PROP AVE E MKD (SEC COR 23 24 25 26 T8N R15W) 2IN IP 3FT UP 2FT N	CL 3372

QUAD-YEAR	ELEV	DESCRIPTION (INCLUDE QUAD AND YEAR IN DESCRIPTION)	BM NUMBER
LANCASTR (1981)	2786.451	CS MON FLUSH ON C/L PROD 170TH ST W 120FT S C/L LANCASTER RD MKD (1/4 COR 35 36 T8N R15W) 2IN IP 3FT UP 2FT NE	CL 3373
LANCASTR (1981)	2770.398	CSBM MON FLUSH 35FT S C/L LANCASTER RD & 0.5MI 160TH ST W MKD (BM 102-36A 1967) 2IN IP 3FT UP 3FT NE	CL 3374
LANCASTR (1981)	2773.120	CSBM MON 6IN UP ON SE COR AVE D & 190TH ST W 86FT S & 32FT E C/L INT MKD (BM 117-42 1961 RE 5869) 2IN IP 3FT UP 2FT W	CL 3375
LANCASTR (1981)	2721.333	X IN S EDGE 2IN IP 5IN UP ON SE COR 190TH ST W & PROP AVE C 30FT S & 30FT E C/L INT	CL 3378
LANCASTR (1981)	2669.646	CS MON 5IN DN @ C/L INT 190TH ST W & AVE B MKD (SEC COR 4 3 9 10 T8N R15W RE 2177) USE S EDGE	CL 3382
LANCASTR (1981)	2661.015	U S GEN LAND OFFICE MON 3IN UP @ C/L INT AVE A & 190TH ST W MKD (33 34 4 3 T8N T9N R15W)	CL 3387
LANCASTR (1981)	2648.662	CS MON @ C/L INT AVE A & 185TH ST W MKD (34 3 T8N T9N R15W)	CL 3388
LANCASTR (1981)	2641.800	U S GEN LAND OFFICE MON 2IN UP @ C/L INT 180TH ST W & AVE A MKD (34 35 3 2 T8N T9N R15W)	CL 3389
LANCASTR (1981)	2614.598	CSBM MON 6IN UP ON SE COR 170TH ST W & AVE A 90FT E & 38FT S C/L INT MKD (BM 117-32 1961) 2IN IP 3FT UP 2FT N	CL 3392
LANCASTR (1981)	2509.717	CSBM MON 6IN DN ON SW COR AVE A & FUTURE 120TH ST W 30FT S & 50FT W C/L INT MKD (BM 117-22 1961) 2IN IP 3FT UP 2FT N (NO BUTTON USED CTR)	CL 3542
LANCASTR (1981)	2537.579	CSBM MON 6IN UP ON SW COR AVE A & 130TH ST W 70FT S & 30FT W C/L INT MKD (BM 117-24 1961) 2IN IP 3FT UP 2FT E	CL 3544
LANCASTR (1981)	2546.492	CS MON IN WELL 11IN DN @ C/L INT AVE A & FUT 135TH ST W MKD (1/4 COR 33 4 R14W T8N T9N) USE SE COR	CL 3545
LANCASTR (1981)	2573.339	CSBM MON 6IN DN ON SW COR AVE A & FUTURE 145TH ST W 30FT S & 70FT W C/L INT MKD (BM 117-27 1961) 2IN IP 3FT UP 1FT N	CL 3547
LANCASTR (1981)	2583.770	CS MON IN WELL 14IN DN @ C/L INT AVE A & FUT 150TH ST W MKD (SEC COR 5 6 32 31 R14W T8N T9N) USE E EDGE	CL 3548

QUAD-YEAR	ELEV	DESCRIPTION (INCLUDE QUAD AND YEAR IN DESCRIPTION)	BM NUMBER
LANCASTR (1981)	2609.824	CSBM MON 6IN UP ON SE COR FUT 165TH ST W & AVE A 40FT S & 50FT E C/L INT MKD (BM 117-31 1961) 2IN IP 3FT UP 2FT N	CL 3552
LANCASTR (1981)	2622.357	CS MON IN WELL 12IN DN @ C/L INT 170TH ST W & AVE B MKD (1 2 11 12 T8N R15W) USE NW EDGE	CL 3554
LANCASTR (1981)	2642.062	CS MON IN WELL 15IN DN @ C/L INT 170TH ST W & FUTURE AVE B-8 MKD (1/4 COR 11 12 R15W T8N RE 2177) S EDGE	CL 3555
LANCASTR (1981)	2663.801	CS MON 22IN DN @ C/L INT 170TH ST W & FUT AVE C MKD (11 12 13 14 T8N R15W RE2177)	CL 3556
LANCASTR (1981)	2681.655	CSBM MON FLUSH ON SE COR 170TH ST W & FUT AVE C-8 59FT E/O TRAVELED RD WAY & 98FT S C/L INT MKD (BM 117-37 1961) 2IN IP 3FT UP 2FT W	CL 3557
LANCASTR (1981)	2798.362	CSBM MON 6IN UP 29FT E C/L 190TH ST W & 0.5MI S AVE D MKD (MB 117-43 1961 RE 5869) 41FT S/O PP NO 2109370E 2IN IP 3FT UP 2FT W	CL 3558
LANCASTR (1981)	2850.323	CSBM MON 6IN UP ON SW COR 190TH ST W & AVE E-8 91FT W & 91FT S C/L INT MKD (BM 117-45 1961) 116 FT W/O TRAVELED RD WAY 2IN IP 3FT UP 2FT E	CL 3560
LANCASTR (1975)	2583.764	LA CS BM MON 24IN UP 34FT E C/L INT 110TH ST W & 8FT N C/L FUT AVE J-8 MKD (BM 119-26 1961)	CL 3632
LANCASTR (1975)	2537.040	USC&GS REF MON 2IN UP 41FT S & 107FT W C/L INT 110TH ST W & AVE J MKD(SUR 2 NO 5 1968)	CL 3635
LANCASTR (1975)	2487.657	CSBM MON FLUSH 87FT S/O C/L AVE D & 30FT W/O C/L 110TH ST W MKD (BM 119-41 1961) 2IN IP 3FT UP 2FT E	CL 3636
LANCASTR (1981)	2495.679	CS MON IN WELL 8IN DN @ C/L INT AVE A & FUTURE 115TH S W MKD (1/4 COR 35 2 T8N T9N R14W) USE W EDGE	CL 3994
LANCASTR (1981)	2510.985	RDBM TAG IN NW CONC FOOTING OF TRANSMISSION TOWER NO 41-1 51FT E C/L FUTURE 120TH ST W & 66FT S C/L AVE A	CL 3995
LANCASTR (1981)	2536.610	1 1/2IN IP W/CONC PLUG & BR FLUSH 50FT E & 50FT S C/L INT AVE A & 130TH ST W (USE CTR) 2IN IP 3FT UP 2FT N	CL 3997
LANCASTR (1981)	2561.327	CS MON IN WELL 10IN DN @ C/L INT AVE A & 140TH ST W MKD (SEC COR 32-33-5-4 T8N T9N R14W) USE W EDGE	CL 3998

QUAD-YEAR	ELEV	DESCRIPTION (INCLUDE QUAD AND YEAR IN DESCRIPTION)	BM NUMBER
LANCASTR (1981)	2571.706	CS MON IN WELL @ C/L INT AVE A & 145TH ST W MKD (1/4 COR 32-5 T8N T9N R14W) USE NE EDGE	CL 3999
LANCASTR (1981)	2595.130	RDBM TAG IN CONC COLLAR OF IRRIGATION VALVE 32FT N C/L AVE A & 36FT E C/L FUTURE 155TH ST W	CL 4001
LANCASTR (1981)	2603.224	CS MON IN WELL @ C/L INT AVE A & FUTURE 160TH ST W MKD (SEC COR 36 31 1 6 T9N T8N R15W R14W)	CL 4002
LANCASTR (1981)	2613.690	CS MON 4IN DN 42FT S & 42FT E/O C/L INT AVE A & 170TH ST W MKD (FAIRMONT BUTTE RM 2 1970 RE 5869) 4IN STEEL FENCE POST 5FT NW	CL 4004
LANCASTR (1981)	2628.441	L & BN IN NE COR CONC SLAB OF IRRIGATION PUMP 34FT E FUTURE 175TH ST W & 186FT N AVE A MKD(BM)	CL 4005
LANCASTR (1981)	2660.510	STANDARD CS BR CAP MON 4IN UP 44FT N & 42FT W C/L INT AVE A & 190TH ST W MKD (FAIRMONT BUTTE RM2 1970 RE 5869)	CL 4006
LANCASTR (1981)	2665.190	RDBM MON IN WELL 30FT E C/L 190TH ST W & 0.5MI S/O AVE A & FUTURE AVE A-8 18IN E/O PP NO. 2038421E	CL 4007
LANCASTR (1981)	2720.159	STANDARD CS BR CAP MON FLUSH 45FT N & 45FT E C/L INT AVE C & 190TH ST W MKD (FAIRMONT BUTTE E-11 RM2 1970 RE 5869)	CL 4008
LANCASTR (1981)	2720.494	STANDARD CS BR CAP MON 4IN UP 45FT N & 45FT W C/L INT AVE C & 190TH ST W MKD (FAIRMONT BUTTE E-11 RM2 1970 RE 5869)	CL 4009
LANCASTR (1981)	2746.714	RDBM MON IN WELL 25FT W C/L 190TH ST W & 0.5MI S/O AVE C @ FUTURE AVE C-8 4FT W/O PP NO 1309597 2IN IP 3FT UP 2FT N	CL 4010
LANCASTR (1981)	2823.166	CSBM MON 6IN UP 50FT N & 30FT E INT (DIRT RDS) 190TH ST W & AVE E MKD (BM 117-44A 1972) 2IN IP 3FT UP 2FT W	CL 4011
LANCASTR (1981)	2847.403	CS MON 12IN DN @ C/L INT 190TH ST W & AVE E-8 MKD (1/4 SEC COR 28 27 T8N R15W RE2177) 25FT W/O CTR TRAVELED RD WAY 2IN IP 3FT UP 2FT N USE S EDGE	CL 4012
LANCASTR (1981)	2621.776	RDBM TAG IN SW COR CONC SLAB 43FT N & 105FT E C/L INT 170TH ST W & FUTURE AVE A-8	CL 4014
LANCASTR (1981)	2619.366	CS MON IN WELL @ C/L INT 170TH ST W & FUTURE AVE A-8 MKD (1/4 COR 2 1 T8N R15W) USE W EDGE	CL 4015

QUAD-YEAR	ELEV	DESCRIPTION (INCLUDE QUAD AND YEAR IN DESCRIPTION)	BM NUMBER
LANCASTR (1981)	2624.917	1 1/2IN IP W/CONC PLUG & BR 4IN UP 50FT S & 52FT W C/L INT 170TH ST W & FUTURE AVE B CHIS X ON SW EDGE	CL 4016
LANCASTR (1981)	2643.644	2IN IP W/CONC PLUG & CE TAG 3IN UP 50FT N & 50FT E C/L INT 170TH ST W & AVE B-8 CHIS X ON NW EDGE 2IN IP 3FT UP 2FT E	CL 4017
LANCASTR (1981)	2665.178	CS BM MON 5IN UP 80FT S & 40FT E C/L INT 170TH ST W & FUTURE AVE C MKD (BM 117-36B 1972 RE 7078) 2IN IP 3FT UP 2FT W	CL 4018
LANCASTR (1981)	2559.970	2IN IP W/CONC PLUG & CE TAG 5IN UP 50FT N & 50FT E C/L INT 140TH ST W & FUTURE AVE C-8 CHIS X ON S EDGE	CL 4021
LANCASTR (1981)	2551.744	STANDARD CS BR CAP MON 2IN UP 44FT S & 45FT W C/L INT 140TH ST W & FUTURE AVE C MKD (FAIRMONT BUTTE RM2 1970 RE 5869) 11FT S/O PP NO 1633974E 2IN IP 3FT UP 2FT E	CL 4022
LANCASTR (1981)	2550.872	STANDARD CS BR CAP MON 2IN UP 42FT S & 45FT E C/L INT 140TH ST W & FUTURE AVE C MKD (FAIRMONT BUTTE RM1 1970 RE 5869) 6FT SE/O PP NO 1633945E 2IN IP 3FT UP 2FT W	CL 4023
LANCASTR (1981)	2546.573	1 1/2IN IP W/CONC PLUG & BR 8IN DN 50FT S & 50FT E C/L INT 140TH ST W & FUTURE AVE B-8 12FT SE PP NO 1633933E CHIS X ON E EDGE	CL 4024
LANCASTR (1981)	2553.694	RDBM TAG IN NE COR CONC SLAB OF IRRIGATION PUMP SHED 68FT E C/L 140TH ST W & 56FT S C/L AVE B 25FT ELY PP NO 1491176E	CL 4026
LANCASTR (1981)	2556.165	RDBM MON IN WELL 43FT E/O C/L 140TH ST W & 118FT S/O FUTURE AVE A-8 0.5MI S/O AVE A 4FT N/O PP NO 1491166E 2IN IP 3FT UP 2FT W MKD (1973)	CL 4027
LANCASTR (1981)	3048.786	RDBM MON IN WELL 57FT S & 35FT W C/L INT THREE POINTS RD & LANCASTER RD MKD (1973) 2IN IP 3FT UP 2FT E	CL 4028
LANCASTR (1981)	3123.591	CSBM MON 25FT E C/L THREE POINTS RD & 0.4MI S/O LANCASTER RD 2FT E/O PP NO (GONE) MKD (BM 111-61 1960 RE 5869)	CL 4029
LANCASTR (1981)	3132.801	CSBM MON 25FT W C/L THREE POINTS RD & 0.9MI S/O LANCASTER RD 2FT W/O GUY POLE NO 1200394E MKD (BM 111-60 1960 RE 5869)	CL 4030

QUAD-YEAR	ELEV	DESCRIPTION (INCLUDE QUAD AND YEAR IN DESCRIPTION)	BM NUMBER
LANCASTR (1981)	3205.759	RDBM MON 27FT E C/L THREE POINTS RD & 1.5MI S/O LANCASTER RD 2.5FT W/O PP NP (GONE) MKD (BM 111-59 1960 RE 5869) 2IN IP 3FT UP 2FT W	CL 4031
LANCASTR (1981)	3275.645	CSBM MON 23FT W C/L THREE POINTS RD & 2.0MI S/O LANCASTER RD 2FT W/O PP NO 1938415E MKD (BM 111-58 1960 RE 5869)	CL 4032
LANCASTR (1981)	3342.448	CSBM MON 41FT W C/L THREE POINTS RD & 2.5MI S/O LANCASTER RD 3.5FT N/O PP NO 1938408E MKD (BM 111-57 1960 RE 5869) 2IN IP 3FT UP 2FT N	CL 4033
LANCASTR (1981)	3428.447	CSBM MON 34FT E C/L THREE POINTS RD & 27FT N/O C/L PINE CYN RD 3FT S/O PP NO 1200318E MKD (BM 111-56 1960 RE 5869) 2IN IP 3FT UP 2FT S	CL 4034
LANCASTR (1981)	3429.788	RDBM TAG IN CONC SLAB OF THREE POINTS CAFE (LOWER SLAB) 48FT W C/L THREE POINTS RD & 44FT S C/L PINE CYN RD	CL 4035
LANCASTR (1981)	3464.926	RDBM TAG IN CONC FTG OF BARB WIRE FENCE 20FT S C/L PINE CYN RD & 0.5MI W/O THREE POINTS RD ON E SIDE OF DIRT DR TO HIDDEN ACRES (HSE NO 26876)	CL 4036
LANCASTR (1981)	3551.928	RDBM MON IN WELL MKD (1973) 20FT N C/L PINE CYN RD & 1.0MI W/O THREE POINTS RD 5FT N/O LACFD POLE NO (GONE) & 5FT W/O PP NO 2227471E 2IN IP 3FT UP 2FT N	CL 4038
LANCASTR (1981)	3641.200	CE PROP COR MON FLUSH 18FT S C/L PINE CYN RD & 1.45MI W/O THREE POINTS RD 587FT W/O C/L SECOMBRE RD MKD (PROP COR RE 5869) 2IN IP 3FT UP 2FT NE	CL 4040
LANCASTR (1981)	3810.567	RDBM MON IN WELL MKD (1973) 30FT N C/L PINE CYN RD & 2.0MI W/O THREE POINTS RD 22FT E/O DIRT DR TO HINDLAND GUN CLUB 100FT W/O MI POST NO 11.66 2IN IP 3FT UP 2FT S	CL 4041
LANCASTR (1981)	2528.192	RDBM MON IN WELL 45FT N C/L AVE D & 159FT W C/L 125TH ST W 10FT E/O PP (NONE) MKD (1961) 2IN IP 3FT UP 1FT N	CL 4042
LANCASTR (1981)	2971.165	CALIF STATE DEPT OF WATER RESOURCES MON IN N CB OF CALIF AQUADUCT 21FT W/O E END OF CB 23FT N C/L AVE D & 391FT E C/L 245TH ST W MKD(3136A 1971)	CL 4045
LANCASTR (1981)	2971.482	BOLT IN S CB OF CALIF AQUADUCT 24FT E/O W END CB 23FT S C/L AVE D & 301FT E C/L 245TH ST W	CL 4046

QUAD-YEAR	ELEV	DESCRIPTION (INCLUDE QUAD AND YEAR IN DESCRIPTION)	BM NUMBER
LANCASTR (1981)	2903.362	LACS MON 5IN UP 94FT N & 44FT E C/L INT 210TH ST W & LANCASTER RD MKD(NEENACH SCHOOL 0-14 RMI 1970) 2IN IP 3FT UP 2FT W	CL 4047
LANCASTR (1981)	2861.052	RDBM TAG 2FT N/O S END HDWL 25FT N C/L LANCASTER RD & 22FT E/O DR TO HSE NO 18303 0.6MI E/O 190TH ST W	CL 4049
LANCASTR (1981)	2902.899	CS MON 20IN DN 84FT W & 150FT S C/L LANCASTER RD & FUTURE 195TH ST W MKD(1/4 SEC COR 28 33 T8N R15W) 2IN IP 3FT UP 2FT E USE S EDGE	CL 4050
LANCASTR (1981)	2953.001	CALIF STATE DEPT OF WATER RESOURCES MON 5IN DN 50FT W C/L EXISTING PVMT LANCASTER RD & 0.5MI W/O FUTURE 195TH ST W ANGLE IRON MKR 3FT UP 1FT N MKD(M 2 171) USE E EDGE OF CTR BUTTON	CL 4051
LANCASTR (1981)	2518.177	USC&GS MON 2IN UP 28FT N/O C/L AVE I & 315FT E/O C/L 115TH ST W MKD (B 1220 1971) 2IN IP 2FT E 3FT UP	CL 4052
LANCASTR (1981)	2941.059	RDBM TAG IN FTG OF FENCE POST 60FT E C/L MUNZ RANCH RD 10FT S C/L ACCESS RD TO STATE OF CALIF AQUADUCT 1.6MI N/O ELIZABETH LAKE RD	CL 4053
LANCASTR (1975)	2859.969	1 1/2IN IP W/CONC PLUG & BR 10IN DN @ BC 37FT N/O JOHNSON RD & 218FT W C/L PROD 110TH ST W 94FT E PP NO 1897439E (USE S EDGE)	CL 4055
LANCASTR (1981)	3831.745	RDBM TAG IN LARGE ROCK 27FT N C/L PINE CYN RD & 2.9MI W/O THREE POINTS RD	CL 4057
LANCASTR (1981)	3831.701	RDBM MON IN WELL MKD (1973) 22FT S C/L PINE CYN RD & 2.9MI W/O THREE POINTS RD 2IN IP 3FT UP 2FT N	CL 4058
LANCASTR (1981)	3827.225	RDBM MON IN WELL MKD (1973) 25FT N C/L PINE CYN RD & 3.4MI W/O THREE POINTS RD 14FT NE OF FIRE POLE & 13FT N/O 48IN OAK TREE 2IN IP 3FT UP 2FT S	CL 4059
LANCASTR (1981)	3966.689	RDBM MON IN WELL MKD (1973) 27FT S C/L PINE CYN RD 3.8MI W/O THREE POINTS RD 27FT E/O C/L DIRT RD TO CAMP GROUND HORSE TAIL 15FT E/O FIRE CALL BOX NO 77-5 2IN IP 3FT UP 2FT N	CL 4060
LANCASTR (1981)	3965.916	RDBM MON IN WELL MKD (1973) 27FT S C/L PINE CYN RD & 3.8MI W/O THREE POINTS RD 20FT W/O DIRT RD TO CAMP GROUND HORSE TRAIL 2IN IP 3FT UP 2FT N	CL 4061

QUAD-YEAR	ELEV	DESCRIPTION (INCLUDE QUAD AND YEAR IN DESCRIPTION)	BM NUMBER
LANCASTR (1981)	3802.190	RDBM MON IN WELL 20FT N C/L PINE CYN RD & 4.6MI W/O THREE POINTS RD @ TOP OF SMALL HILL 5FT SE/O FIRE POLE 2IN IP 3FT UP 2FT S	CL 4062
LANCASTR (1981)	3770.059	RDBM TAG IN CONC FTG OF 1.5IN STEEL SIGN POST 17FT N C/L PINE CYN RD & 4.9MI W/O THREE POINTS RD 7FT N/O FIRE POLE	CL 4063
LANCASTR (1981)	3769.706	RDBM MON IN WELL MKD (1973) 20FT S C/L PINE CYN RD & 4.9MI W/O THREE POINTS RD 10FT S/O 30 IN OAK TREE 2IN IP 3FT UP 2FT N	CL 4064
LANCASTR (1981)	3664.286	RDBM TAG IN CONC WALL OF CATTLE GUARD @ ENT TO RANCHO CORONA DEL VALLE 37FT WLY C/L PINE CYN RD & 5.3MI W/O THREE POINTS RD 20FT SW/O FIRE CALL BOX NO 77-1	CL 4065
LANCASTR (1981)	3584.700	RDBM MON IN WELL MKD (1973) 35FT N C/L PINE CYN RD & 5.75MI W/O THREE POINTS RD 20FT S/O PP NO 1185314E 2IN IP 3FT UP 2FT S	CL 4066
LANCASTR (1981)	3563.234	RDBM MON IN WELL MKD (1973) 25FT S C/L PINE CYN RD & 6.3MI W/O THREE POINTS RD 35FT SE/O MILE MKR 15.91 80FT E/O PP NO 1185324E 2IN IP 3FT UP 2FT N	CL 4067
LANCASTR (1981)	3746.045	RDBM MON IN WELL MKD (1973) 30FT W C/L PINE CYN RD & 7.0MI W/O THREE POINTS RD 2IN IP 3FT UP 3FT E	CL 4068
LANCASTR (1981)	3841.866	2IN IP W/CONC PLUG & RCE TAG 11467 2IN UP 18FT W C/L PINE CYN RD 7.5MI W/O THREE POINTS RD 25FT SE/O COR OF BARN CHANNEL IP 4FT UP 1FT W MKD LINE	CL 4069
LANCASTR (1981)	3866.778	RDBM TAG IN CONC FTG OF FENCE POST @ CONC WK TO HSE NO 32633 15FT W C/L PINE CYN RD & 7.55MI W/O THREE POINTS RD	CL 4070
LANCASTR (1981)	4009.594	CSBM MON 4IN UP 25FT W C/L OLD RIDGE RTE RD & 19FT S C/L PINE CYN RD MKD(BM 208-9 1968) 2IN IP 3FT UP 2FTE	CL 4071
LANCASTR (1981)	4008.405	RDBM TAG IN CTR CONC HDWL OF C B NO 2.55 20FT W C/L OLD RIDGE RTE RD & 27FT N C/L PINE CYN RD	CL 4072
LANCASTR (1981)	3932.016	USC&GS MON 3IN UP 50FT N C/L OLD RIDGE RTE RD & 0.45MI N/O PINE CYN RD 1.9MI SELY LANCASTER RD MKD(D-370 1953) SURVEY MKR 3FT UP 1.5FT SE	CL 4073

QUAD-YEAR	ELEV	DESCRIPTION (INCLUDE QUAD AND YEAR IN DESCRIPTION)	BM NUMBER
LANCASTR (1981)	3896.396	USC&GS MON SET VERTICALLY IN FACE OF CUT BANK 3FT ABOVE LEVEL OF RD 17FT S C/L OLD RIDGE RTE RD & 1.75MI SELY LANCASTER RD 252FT ELY RD SIGN NO 2.05 MKD(U-991-1965)	CL 4074
LANCASTR (1981)	3823.922	CSBM MON IN CONC HDWL OF CULV NO 1.80 21FT N C/L OLD RIDGE RTE RD & 1.55MI SELY LANCASTER RD 1.5FT E/O W END HDWL MKD(BM 208-6 1968)	CL 4075
LANCASTR (1981)	3785.244	CS MON FLUSH 28FT E C/L OLD RIDGE RTE RD & 1.4MI SELY LANCASTER RD MKD(LA LIEBRE RANCH E-15 1971 RE 7078) 2IN IP 3FT UP 3FT W	CL 4076
LANCASTR (1981)	3768.752	CSBM MON 5IN DN 32FT N C/L OLD RIDGE RTE RD & 1.35MI SLY LANCASTER RD MKD(BM 208-5 1968 RE5869 2IN IP 3FT UP 2FT S & 2FT E	CL 4077
LANCASTR (1981)	3667.961	CSBM MON 2IN UP 58FT S C/L OLD RIDGE RTE RD & 1.0MI SELY LANCASTER RD 13FT ELY/O 5FT OAK TREE MKD(208-4 1968) 2IN IP 3FT UP 2FT N	CL 4090
LANCASTR (1981)	3593.278	USC&GS MON 8IN UP 54FT S C/L OLD RIDGE RTE RD & 0.7MI SELY/O LANCASTER RD MKD(X-53 1926) SURVEY MKR 1.5FT UP 1FT S	CL 4091
LANCASTR (1981)	3509.748	CSBM MON IN CONC HDWL NO 0.70 23FT S OLD RIDGE RTE RD & 0.5MI SELY LANCASTER RD MKD(BM 208-2 1968 RE 5869)	CL 4092
LANCASTR (1981)	2952.971	CSBM MON 5IN UP 35FT N C/L LANCASTER RD & 0.5MI E/O 235TH ST W MKD(BM 102-54A 1972) 2IN IP 3FT UP 2FT S	CL 4095
LANCASTR (1981)	2966.934	SPK & L 1FT W/O E END CONC CB OF BRIDGE OVER THE CALIF AQUADUCT 15FT S C/L LANCASTER RD & 214FT W C/L 235TH ST W	CL 4096
LANCASTR (1981)	2967.517	STATE OF CALIF DEPT OF WATER RESOURCES MON 1.5FT W/O E END CONC WK 249FT W C/L 235TH ST W & 16FT N C/L LANCASTER RD MKD(3149-A 1971)	CL 4097
LANCASTR (1981)	3005.788	CSBM MON 6IN UP 45FT W C/L (LANCASTER RD) 245TH ST W & 0.45MI S/O AVE D NR MILE POST 26.66 34FT W/O EDGE PVMT NR MC OF CURVE MKD (BM 102-57A 1972) 2IN IP 3FT UP 2FT E	CL 4098
LANCASTR (1981)	2989.178	RDBM TAG IN CONC FTG OF 4IN STEEL FENCE POST 50FT N C/L LANCASTER RD & 105FT W C/L 270TH ST W @ SE PROP COR OF HSE NO 27011 5FT S/O PP NO 1847251E	CL 4100

QUAD-YEAR	ELEV	DESCRIPTION (INCLUDE QUAD AND YEAR IN DESCRIPTION)	BM NUMBER
LANCASTR (1981)	3039.162	RDBM TAG IN CONC HDWL 1FT N/O S END 27FT S C/L LANCASTER RD & 0.15MI W/O MARAGLO ST (DIRT) 37FT NE/O PP NO 1123692E	CL 4101
LANCASTR (1981)	3021.390	RDBM TAG IN CTR CONC HDWL 22FT S C/L LANCASTER RD & 35FT E C/L 290TH ST W (DIRT) @ DIRT DRIVE TO HSE NO 29300	CL 4102
LANCASTR (1981)	3044.199	RDBM TAG IN CTR OF CONC HDWL 22FT S C/L LANCASTER RD & 135FT W C/L 300TH ST W	CL 4103
LANCASTR (1981)	3114.854	RDBM TAG IN CTR OF CONC HDWL OF BRIDGE NO 53-545 22FT S C/L LANCASTER RD & 125FT E/O DIRT RD W/CATTLE GUARD 3.4MI E/O OLD RIDGE RTE RD	CL 4104
LANCASTR (1981)	3168.848	RDBM TAG IN NE COR CONC HDWL OF CULV 22FT S C/L LANCASTER RD & 2.4MI E/O OLD RIDGE RTE RD	CL 4105
LANCASTR (1981)	3287.486	RDBM TAG IN CTR CONC HDWL NO A-75+78 22FT N C/L LANCASTER RD & 1.3MI E/O OLD RIDGE RTE RD 105FT E/O PP NO 1061984E	CL 4106
LANCASTR (1981)	3408.015	USC&GS MON IN E END OF CONC HDWL OF BRIDGE NO 53-5 23FT N C/L LANCASTER RD & 0.3MI E/O OLD RIDGE RTE RD MKD(H1044 1960)	CL 4107
LANCASTR (1981)	3327.830	STATE OF CALIF DEPT OF WATER RESOURCES MON 6IN UP 140FT S C/L LANCASTER RD & 0.6MI W/O OLD RIDGE RTE RD MKD(ORP-7 1968) MKR POST 3FT UP 3FT S	CL 4110
LANCASTR (1981)	3330.664	STATE OF CALIF DEPT OF WATER RESOURCES MON 5IN UP 40FT N C/L LANCASTER RD & 1.9MI W/O OLD RIDGE RTE RD 107FT W/O MAC DR INTO STATE OF CAL PROPERTY 17FT NW PP NO 1061900E MKD(OC W2-58 1968) SURVEY MKR 2FT UP 2FT W	CL 4114
LANCASTR (1981)	3330.269	USC&GS MON FLUSH 43FT N C/L N BARREL LANCASTER RD 2.2MI W/O OLD RIDGE RTE RD 50FT W/O PP NO (NONE) MKD (Z 973 1964 RESET 1965) SURVEY MKR POST 2FT UP 1FT E	CL 4115
LANCASTR (1981)	3329.180	USC&GS MON 2IN UP 77FT N C/L N BARREL LANCASTER RD 2.25MI W/O OLD RIDGE RTE RD 105FT E/O PP NO 1061891E MKD(X-973 1964 RESET 1965) SURVEY MKR POST 2FT UP 1.5FT E	CL 4116
LANCASTR (1981)	3329.059	USC&GS MON 5IN UP 89FT N C/L N BARREL LANCASTER RD & 2.3MI W/O OLD RIDGE RTE RD 63FT W/O PP NO 1061891E MKD(W 973 1964 RESET 1965) SURVEY MKR POST 2FT UP 2FT W	CL 4117

QUAD-YEAR	ELEV	DESCRIPTION (INCLUDE QUAD AND YEAR IN DESCRIPTION)	BM NUMBER
LANCASTR (1981)	3325.828	USC&GS MON FLUSH 94FT N C/L N BARREL LANCASTER RD & 2.35MI W/O OLD RIDGE RTE RD 4FT W/O PP NO 1061890E MKD (V 973-1964 RESET 1965) SURVEY MKR POST 2FT UP 1.5FT W	CL 4118
LANCASTR (1981)	3503.243	CSBM MON 4IN UP 37FT N C/L GORMAN POST RD & 0.8MI W/O LANCASTER RD MKD (BM 102-88A 1968) 2IN IP 3FT UP 2FT S	CL 4119
LANCASTR (1981)	3544.090	USC&GS MON 5IN UP 39FT S C/L GORMAN POST RD & 2.8MI W/O LANCASTER RD 30FT W/O TP NO 10-41 MKD(H 452 1953) 2IN IP 3FT UP 1.5FT W	CL 4120
LANCASTR (1981)	3646.248	USC&GS MON 40FT N C/L GORMAN POST RD & 1.0MI E/O GORMAN SCHOOL RD 16FT NE/O TP NO 9A-406P MKD(E 452 1953) SURVEY MKR POST 2FT W	CL 4121
LANCASTR (1981)	3747.749	RDBM TAG IN CONC WALL OF DROP INLET NO 4.70 17FT N C/L GORMAN POST RD & 0.5MI E/O GORMAN SCHOOL RD 15FT W/O PP NO 1699131E	CL 4122
LANCASTR (1981)	3782.541	USC&GS MON 5IN UP 89FT N C/L GORMAN POST RD & 0.3MI E/O GORMAN SCHOOL RD 11FT W/O TP NO (GONE) 125FT E/O SE COR OF OLD MAINTENANCE BLDG MKD (Z 368 1953) SURVEY MKR POST 2FT W	CL 4123
LANCASTR (1981)	3814.539	L & T IN CB 48FT N C/L GORMAN POST RD @ C/L PROD OF GORMAN SCHOOL RD	CL 4124
LANCASTR (1981)	3816.670	RDBM TAG IN CONC FTG OF LIGHT STANDARD 177FT S C/L GORMAN POST RD & 42FT W C/L GORMAN SCHOOL RD @ SLY DR TO CHEVRON GAS STATION	CL 4125
LANCASTR (1981)	3906.532	USC&GS MON IN CONC HDWL NO 3.20 1FT E/O W END 48FT S C/L PEACE VALLEY RD & 0.45MI W/O GORMAN SCHOOL RD MKD(N 1219 1971)	CL 4126
BASELINE (1973)	3418.061	RDBM TAG CONC CB @ N/E COR JOHNSON RD & LEADHILL DR 51FT N & 16FT E/O C/L INT	CL 4196
BASELINE (1973)	3477.761	RDBM TAG CONC CB @ N/E COR JOHNSON RD & LIMERIDGE DR 46FT N & 20FT E/O C/L INT	CL 4197
BASELINE (1973)	2901.016	USC&GS MON FL DN JOHNSON RD 0.25MI W/O 110TH ST W 29FT S/O C/L MKD (V 1044 1960)	CL 4198
LANCASTR (1975)	2498.155	1 1/2IN IP CONC PL & BR, 12IN DIA @ SE COR 110TH ST W & AVE I, 45FT S & 52FT E C/L INT (USE S EDGE)	CL 4352

QUAD-YEAR	ELEV	DESCRIPTION (INCLUDE QUAD AND YEAR IN DESCRIPTION)	BM NUMBER
LANCASTR (1975)	2676.152	RDBM MON DN 6IN IN WELL MKD (BM 1974) 50FT N & 60FT E/O C/L INT AVE K & 110TH ST W 2FT N/O WITNESS POST	CL 4358
LANCASTR (1981)	3826.935	COPPER WIRE TOP 6IN CONC POST 4IN DN 1FT S/O LACO SUR BRASS CAP MON MKD (KERN CO LA CO BDRY) 40FT E/O C/L PEACE VALLEY RD & 39FT N/O APPROX C/L FRAZIER MT PK RD	CL 4360
LANCASTR (1981)	4054.916	STATE OF CAL DIV HWY BRASS CAP MON MKD (727&5115 BC C/L) CTR DIRT DIVIDER, 1.4 FT S/O S EDGE CONC C B 50FT E/O MKR POST NO 0.90 ON W'LY EDGE SO BARREL PEACE VALLEY RD 0.8MI S/O FRAZIER MT PK RD	CL 4362
LANCASTR (1981)	4180.607	LACE B MON MKD (BM 102-107 1968 RE 5869) IN SW COR BRIDGE # 53-1779 OVER FRWY, 58FT E'LY APPROX C/L PEACE VALLEY RD 1.3MI S/O APPROX C/L FRAZIER MT PK RD	CL 4363
LANCASTR (1981)	4095.608	LACE B MON MKD (BM102 106-1968 RE 5869) IN S'LY CONC HDWL 2 FT E/O W END 53FT E'LY OF APPROX C/L PEACE VALLEY RD 1.6MI S/O APPROX C/L FRAZIER MT PK RD	CL 4364
LANCASTR (1975)	2493.619	2IN IP CON PLUG & CS TAG 5IN UP 50FT S & 50FT E/O C/L INT 110 TH ST W & AVE G USE PM IN E EDGE	CL 4370
LANCASTR (1975)	2801.430	CS BM 6IN UP 0.5 MI S & 61FT W C/L INT 110TH ST W & AVE K 5FT W/O PP 503791E MKD (119-28A 1972)	CL 4417
LANCASTR (1975)	2785.219	CALIF DIV OF HWY MON 4IN UP 0.35 MI S & 53FT W C/L INT 110TH ST W & AVE K MKD (DEL SUR G10 1972)	CL 4418
LANCASTR (1975)	2584.919	CS BM MON 4IN UP 64FT S & 58FT W C/L INT 110TH ST W & AVE J-8 MKD (119-26A 1972)	CL 4419
LANCASTR (1975)	2504.863	CS BM 4IN UP 348FT S & 56FT E C/L INT 110TH ST W & AVE I-8 MKD (119-24A)	CL 4420
LANCASTR (1975)	2489.677	1 1/2 IN IP W/CONC PLUG & BR 6IN DN 53FT W C/L INT 110TH ST W & AVE F-8 (USE NW EDGE)	CL 4421
LANCASTR (1975)	2485.707	CS MON IN WELL 10IN DN @ C/L INT 110TH ST W & AVE D-8 MKD (1/4 COR 23 24 T8N R14W RE 7078) USE NE EDGE	CL 4422
LANCASTR (1975)	2485.226	RDBM MON IN WELL 4IN DN 170 N & 41FT W C/L INT 110TH ST W & AVE B-8 MKD(1974)	CL 4423

QUAD-YEAR	ELEV	DESCRIPTION (INCLUDE QUAD AND YEAR IN DESCRIPTION)	BM NUMBER
LANCASTR (1981)	2904.640	LACS MON IN HAND HOLE ON C/L 210TH ST W & 50FT N/O C/L LANCASTER RD MKD (19-20-30-29 R15W T8N RE 2177) USE E EDGE	CL 4600
LANCASTR (1981)	2953.087	RDBM TAG IN SE COR SLAB OF MOST WLY PINIC AREA SHELTER 365FT E/O C/L 210TH ST W & 100FT N/O CENTER OF BIKE PATH ON N/SIDE OF CALIF AQUEDUCT	CL 4601
LANCASTR (1981)	2963.998	L&BN IN CONC BASE OF 4FT WOVEN WIRE FENCH POST ON S/SIDE OF CALIF AQUEDUCT 184FT N/O AVE E-8 & 40FT E/O 210TH ST W	CL 4602
LANCASTR (1981)	2966.973	CS MON DN 12IN @ C/L INT 210TH ST W & AVE E-8 MKD (1/4 COR 30-29 T6N R15W RE 2177) USE W EDGE 2IN IP 3FT UP 2FT SE	CL 4603
LANCASTR (1981)	3054.287	CS MON DN 15IN @ INT 210TH ST W & AVE F 117FT S/O CONC STRIP OF LOS ANGELES AQUEDUCT MKD (30-29-31-32 T8N R15W RE2177) USE SLY EDGE 2IN IP 3FT UP 2FT NW	CL 4604
LANCASTR (1981)	3148.071	CS MON DN 10IN @ C/L INT 210TH ST W & AVE F-8 100FT E/O PP #1560066E MKD (1/4 COR 31-32 R15W T8N RE 2177) USE N EDGE 2IN IP 2FT UP 1FT SE	CL 4605
LANCASTR (1981)	3149.879	2IN IP CONC PLUG & LACS TAG UP 4IN ON C/L 210TH ST W & 40FT S/O AVE F-8 107FT SE OF PP NO 1560066E (USE CTR OF TAG)	CL 4606
LANCASTR (1981)	3163.585	CS MON DN 12IN @ C/L INT AVE G & 210TH ST W 2FT N/O PP (NO NUMBER) & 27FT S/O GUY POLE #K10096Y MKD (31-32-6-5 T7N R15W RE2177)	CL 4607
LANCASTR (1981)	3166.035	4IN IP W/BRASS CAP UP 18IN 4FT E/O C/L INT AVE G & 210TH ST W 29FT S/O GUY POLE #K10096Y MKD (FOREST RESERVE BOUNDRY POST #68)	CL 4608
LANCASTR (1981)	3302.086	CS MON DN 12IN @ C/L INT AVE G & 215TH ST W 77FT NW OF PP #1769428E MKD (1/4 COR 31-6 T7N R15W RE 2177) 2IN IP 3FT UP 2FT N	CL 4609
LANCASTR (1981)	3303.970	1IN IP CONC PLUG & LACE TAG DN 20IN ON C/L AVE G 41FT W/O C/L INT 215TH ST W 105FT NW PP NO 1769429E & 129FT W/O PP NO 1769428E 2IN IP 3FT UP 2FT S	CL 4610
LANCASTR (1981)	3285.937	L&T ON CONC WALL W SIDE OF DRIVE TO HSE NO 15003 ELIZABETH LAKE RD 31FT N/O C/L AND 360FT SELY C/L INT HUNGRY JACK RD	CL 4709

QUAD-YEAR	ELEV	DESCRIPTION (INCLUDE QUAD AND YEAR IN DESCRIPTION)	BM NUMBER
LANCASTR (1981)	3300.005	RDBM MON IN WELL 8IN DN 41FT WLY C/L MUNZ RANCH RD & 113FT NLY C/L ELIZABETH LAKE RD 12FT SW PP GT 58461 2IN IP 2FT SLY 3FT UP	CL 4710
LANCASTR (1981)	3238.545	RDBM TAG IN HDWL 19FT ELY C/L MUNZ RANCH RD .55 MI N ELIZABETH LAKE RD 95FT SLY PP 307253	CL 4711
LANCASTR (1981)	2937.616	CS MON DN 10IN 29FT E/O C/L MUNZ RANCH RD 31FT N/O C/L ACCESS RD TO STATE OF CALIF AQUEDUCT 1.6 MI N/O ELIZABETH LAKE RD MKD (RE 7078) USE W ED	CL 4712
LANCASTR (1981)	2796.548	RDBM MON IN WELL 7IN DN 49FT NWLY C/L MUNZ RANCH RD 2.1MI N ELIZABETH LAKE RD 250FT NE MILEAGE MARKER 2.30 2IN IP 2FT ELY 3FT UP	CL 4713
LANCASTR (1981)	2738.489	CSBM MON DN 4IN 35FT WLY C/L MUNZ RANCH RD 2.5MI N ELIZABETH LAKE RD 5FT N PP NO 294508E 2IN IP 2 FT SE 3FT UP MKD (BM 113-5 A 1976 RE 22726)	CL 4714
LANCASTR (1981)	2555.368	RDBM TAG @ SOUTH END HDWL 28FT E/O CTR MUNZ RANCH RD & 440FT S/O C/L LANCASTER RD 16FT NW GUY POLE & 58FT E/O POWER POLE MKD (BM)	CL 4715
LANCASTR (1981)	3305.872	CSBM MON @ W END HDWL NR MILEAGE MKR 18.13 18FT N C/L ELIZABETH LAKE RD .65MI WLY MUNZ RANCH RD MKD (BM 111-338 1972 RE 7078)	CL 4716
LANCASTR (1981)	3260.157	RDBM TAG IN E EDGE CONC DR OF ENTRANCE TO COUNTY FIRE STA PINE CANYON 42FT N/O ELIZABETH LAKE RD & .5MI ELY MOUNTAIN VIEW RD 22FT NWLY TP 110-74 MKD (RDBM)	CL 4717
LANCASTR (1981)	3240.171	USC&GS MON @ S END OF E WING WALL S SIDE OF STREET @ MILEAGE MKR 19.19 30FT SLY C/L ELIZABETH LAKE RD & 40FT ELY C/L INT MOUNTAIN VIEW RD MKD (R 975 RESET 1967)	CL 4718
LANCASTR (1981)	3240.230	LACS TAG IN NW CORN OF WALK ON BRIDGE NO 1686 @ MILEAGE MKR 19.19 19FT N/O C/L ELIZABETH LAKE RD & 25FT E/O C/L INT MOUNTAIN VIEW RD	CL 4719
LANCASTR (1981)	3237.153	L&T IN NE COR CONC DR TO HSE NO 17826 29FT SLY C/L ELIZABETH LAKE RD & 240FT E/O NOBLETT DR	CL 4720
LANCASTR (1981)	3242.160	CS MON IN WELL 12IN DN @ OR NEAR C/L INT ELIZABETH LAKE RD & LAKE HUGES RD MKD (RE 5869) USE WLY EDGE	CL 4721
LANCASTR (1981)	2544.804	CS MON 18IN DN 3FT N C/L PROD AVE I & 40FT E C/L PROD 120TH ST W 55FT SE/O PP NO 2109621E MKD (10 11 15 14 R14W T7N RE 2177)	CL 4722

QUAD-YEAR	ELEV	DESCRIPTION (INCLUDE QUAD AND YEAR IN DESCRIPTION)	BM NUMBER
LANCASTR (1981)	2748.016	CS MON IN WELL 12IN DN NR C/L LANCASTER RD 2.9MI W MUNZ RANCH RD NR C/L DIRT RD TO N MKD (1/4 COR SEC 5 6 T7N R14W RE 5869) USE S EDGE	CL 4723
LANCASTR (1981)	2769.101	CS MON 6IN DN IN WELL & COVER 11FT S/O C/L LANCASTER RD & 0.5MI E/O 160TH ST W MKD (T7N R14W CTR SEC 6 RE 7078) USE N EDGE	CL 4724
LANCASTR (1981)	2783.111	CALIF DIV OF HIGHWAYS MON IN CONC BASE 4IN UP 36FT E/O C/L LANCASTER RD (167TH ST W) @ AVE F-8 & 74FT S/O PP NO 1955042E MKD (BM 2786 RM 2 1972) 2IN IP MKR 2.5 S 3FT UP	CL 4725
LANCASTR (1981)	2872.023	L&T IN E END HDWL 23FT S/O CTR TRAVELED LANCASTER RD (CURVE) & 115FT W/O C/L PROD 190TH ST W @ AVE F	CL 4726
LANCASTR (1981)	2870.975	L&T IN E END HDWL 37FT N/O CTR TRAVELED LANCASTER RD (CURVE) & 74FT W/O C/L PROD 190TH ST W @ AVE F	CL 4727
LANCASTR (1981)	2521.432	CS MON IN WELL 11IN DN @ C/L INT AVE A & FUTURE 125TH ST W MKD (1/4 COR 343 T8N T9N R14W) USE WEST EDGE	CL 4728
LANCASTR (1981)	2562.899	CSBM MON FLUSH ON NE COR AVE A & 140TH ST W 43FT N & 76FT E/O C/L INT MKD (BM 117-26A 1976 RE 22726) 2IN IP 3FT UP 2FT SE	CL 4729
LANCASTR (1981)	2585.729	CS MON FLUSH 45FT E & 45FT N/O C/L INT AVE A & FUT 150TH ST W MKD (FAIRMONT BUTTE M-7 RM-1 1970 RE 5869) 2IN IP 3FT UP 2FT SW	CL 4730
LANCASTR (1981)	2592.963	CS MON 10IN DN IN WELL @ FUTURE 155TH ST W & AVE A MKD (T9N & T8N R14W SEC 6 31 1/4 COR RE 2177) USE N EDGE	CL 4731
LANCASTR (1981)	2608.256	CS MON 8IN DN IN WELL @ C/L INT FUTURE 165TH ST W & AVE A MKD (1/4 SEC 36-1 T8N T9N R15W RE 5869) USE E EDGE	CL 4732
LANCASTR (1981)	2625.490	CS MON 12IN DN @ C/L INT AVE A & FUTURE 175TH ST MKD (T9N T8N R 15W SEC 3 5 2 1/4 COR RE 5869) USE S EDGE 68FT SW OF PP NO 1875601E & 140FT SW OF PP NO 1870500E	CL 4733
LANCASTR (1981)	2561.626	RDBM TAG IN SE COR TELEPHONE VAULT 41FT W & 60FT N/O C/L 140TH ST W & FUTURE AVE C-8	CL 4734
LANCASTR (1981)	2547.723	RDBM TAG IN N EDGE CONC AROUND WATER M H 29FT W & 49FT S/O C/L 140TH ST W & FUTURE AVE B-8	CL 4735

QUAD-YEAR	ELEV	DESCRIPTION (INCLUDE QUAD AND YEAR IN DESCRIPTION)	BM NUMBER
LANCASTR (1981)	2552.090	CS MON IN RD DEPT H H @ C/L INT AVE B & 140TH ST W MKD (SEC 5 4 8 9 T8N R14W) USE N EDGE	CL 4736
LANCASTR (1981)	2555.422	CS MON IN WELL 18IN DN @ INT 140TH ST W & FUTURE A-8 MKD (T8N R14W SEC 4 & 5 1/4 COR SEC) USE W EDGE	CL 4737
LANCASTR (1981)	2776.260	L A WATER DEPT MON 3IN DN 25FT S/O & 32FT W/O TRAVELED ROADWAYS OF AVE F (DIRT RD) & 170TH ST W MKD (ANGLE PT 2ND L-A-A 1971) 2IN IP 3FT UP 2 FT E USE CTR	CL 4738
LANCASTR (1981)	2757.008	LACE MON 2IN UP 50FT S & 62FT W/O CTR TRAVELED RD WAYS 170TH ST W & AVE E-8 (DIRT) MKD (FAIRMONT BUTTE RM-1 I 15 1971 RE5869) 2IN IP 3IN UP 2FT N USED CTR	CL 4739
LANCASTR (1981)	2756.753	LACE MON 2IN UP 50FT N & 63FT W/O CTR TRAVELED RD WAYS 170TH ST W & AVE E-8 (DIRT) MKD (FAIRMONT BUTTE RM 2I 15 1971 RE 5869) 2IN IP 3FT UP 2FT SE USED CTR	CL 4740
LANCASTR (1981)	2735.704	L A WATER DEPT IRON CAP 10IN DN 25FT N/O & 23FT W/O TRAVELED RD WAYS AVE E & 170TH ST W MKD (2ND L-A-A ANGLE PT L S 3571) 2IN IP MKR 3FT UP 2 FTE	CL 4741
LANCASTR (1981)	2711.746	L A WATER DEPT MON 3IN DN 32FT W/O TRAVELED RD WAY 170TH ST W & ON C/L PROP AVE D-8 MKD (2ND L-A-A 1971) IRON T POST MKR 1FT W	CL 4742
LANCASTR (1981)	2679.752	CSBM MON FLUSH 57FT E CTR TRAVELED RD WAY 170TH ST W & 146FT N/O FUTURE C-8 MKD (BM 117-37A RE 22726 1976) 4FT S PP NO 1922923E 2IN IP 3FT UP 2FT SW	CL 4743
LANCASTR (1981)	2744.590	CS MON IN WELL 13IN DN @ INT 190TH ST W & FUTURE AVE C-8 MKD (RE 2177 1/4 COR 15-16 T8N R15W) 8FT W/O CTR TRAVELED RD WAY	CL 4744
LANCASTR (1981)	2695.276	CS MON IN WELL 23IN DN @ C/L INT B-8 & 190TH ST W MKD (T8N R15W 1/4 SEC 9 10 RE 2177) 5FT W/O TRAVELED RD WAY & 0.5MI N/O AVE C	CL 4745
LANCASTR (1981)	2670.100	RDBM MON IN WELL 6IN DN 47FT S & 37FT E/O C/L INT 190TH ST & AVE B MKD (1981) 3FT E/O PP NO 203865E 2IN IP MKR 3FT UP 2FT E	CL 4746
LANCASTR (1981)	3378.505	RDBM MON IN WELL MKD (1981) 44FT N C/L LANCASTER RD & 197FT E/O APPROX C/L INT OLD RIDGE RTE RD 5FT N PP NO (GONE) 2IN IP MKR 3FT UP 2FT N	CL 4747

QUAD-YEAR	ELEV	DESCRIPTION (INCLUDE QUAD AND YEAR IN DESCRIPTION)	BM NUMBER
LANCASTR (1981)	3377.505	RDBM TAG IN CTR CONC HDWL TO CULV 55FT S C/L LANCASTER RD & 55FT E C/L OLD RIDGE RTE RD (FROM MC OF CURVE) 104FT W/O GUY POLE NO 1061955E	CL 4748
LANCASTR (1981)	3974.592	RDBM TAG TOP OF STONE & MORTAR GATE COR POST 3FT UP ON W SIDE OF PVT DR (DIRT) 19FT N C/L PINE CYN RD & 2.5MI W/O THREE POINTS RD	CL 4749
LANCASTR (1981)	3329.859	RDBM TAG IN W CB (2FT S OF END) IN W DRWY HSE NO 68 CIRCLE K RANCH 54FT S C/L LANCASTER RD 1.1MI W/O OLD RIDGE RTE RD	CL 4750
LANCASTR (1981)	3322.519	RDBM TAG IN CTR HDWL NO 108+17 37FT S C/L LANCASTER RD & 1.3MI W/O OLD RIDGE RTE RD	CL 4751
LANCASTR (1981)	3988.991	RDBM TAG IN CB OF C B CTR DIRT DIVIDER 4FT S/O C B MKR POST NO 0.70 PEACE VALLEY RD 0.6MI S/O APPROX C/L FRAZIER MT PK RD	CL 4752
LANCASTR (1981)	3821.778	RDBM TAG IN E END OF CONC GAS PUMP ISLAND 92FT W/O APPROX C/L PEACE VALLEY RD & 155FT N/O APPROX C/L FRAZIER MT PK RD	CL 4753